

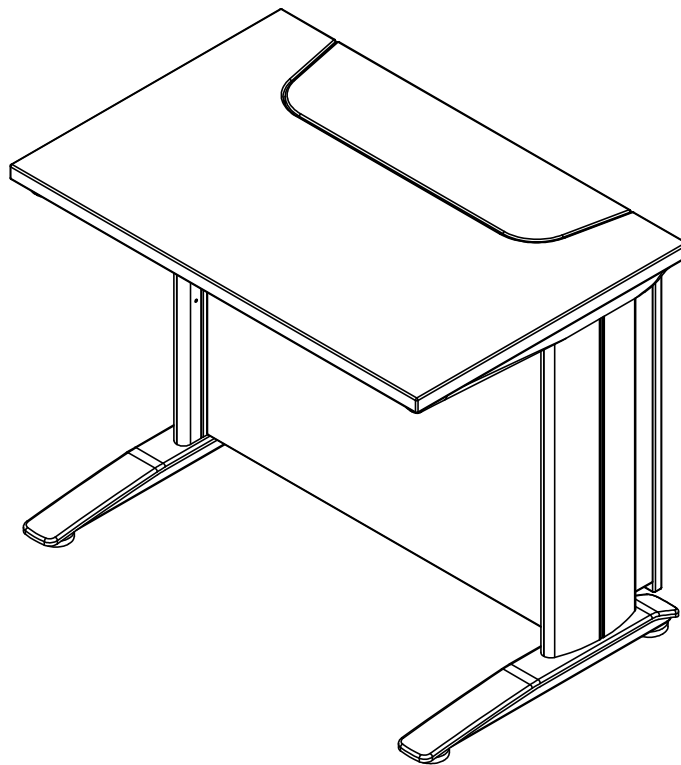

K&A Manufacturing
6703 Zinser Street
Schofield, WI 54476
Phone: 800.298.4351
Fax: 866.882.9475
www.raproducts.com
6/13/17

Series 4 HV Single Monitor Lift Assembly Instructions



Read all the instructions before beginning.



K&A Manufacturing
6703 Zinser Street Schofield, WI 54476
Phone: 800.298.4351
Fax: 866.882.9475
www.raproducts.com

Tools Required for Assembly:
Power Driver W/Adjustable Torque
#2 Phillips Head Driver Bit
#2 Square Head Driver Bit
Phillips Screwdriver
3/16" Hex Head Driver Bit or
Allen Wrench
Level
Square
Tape Measure

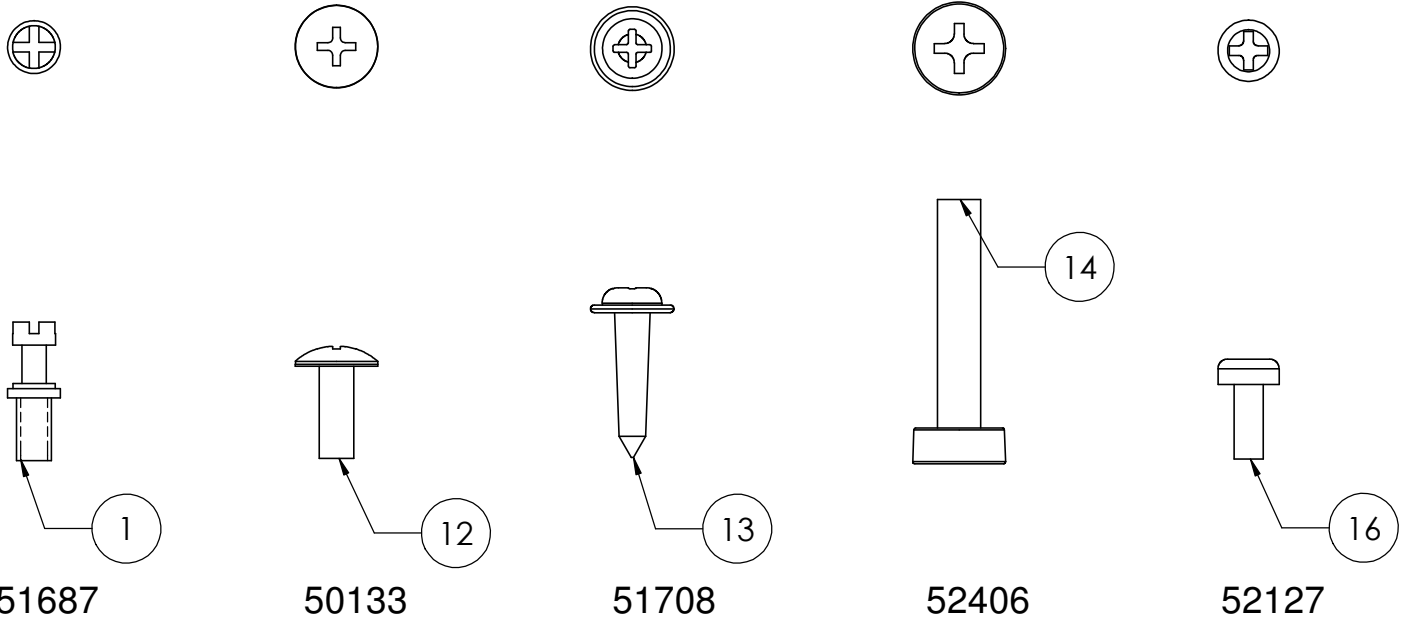

Hardware Is Drawn Actual Size

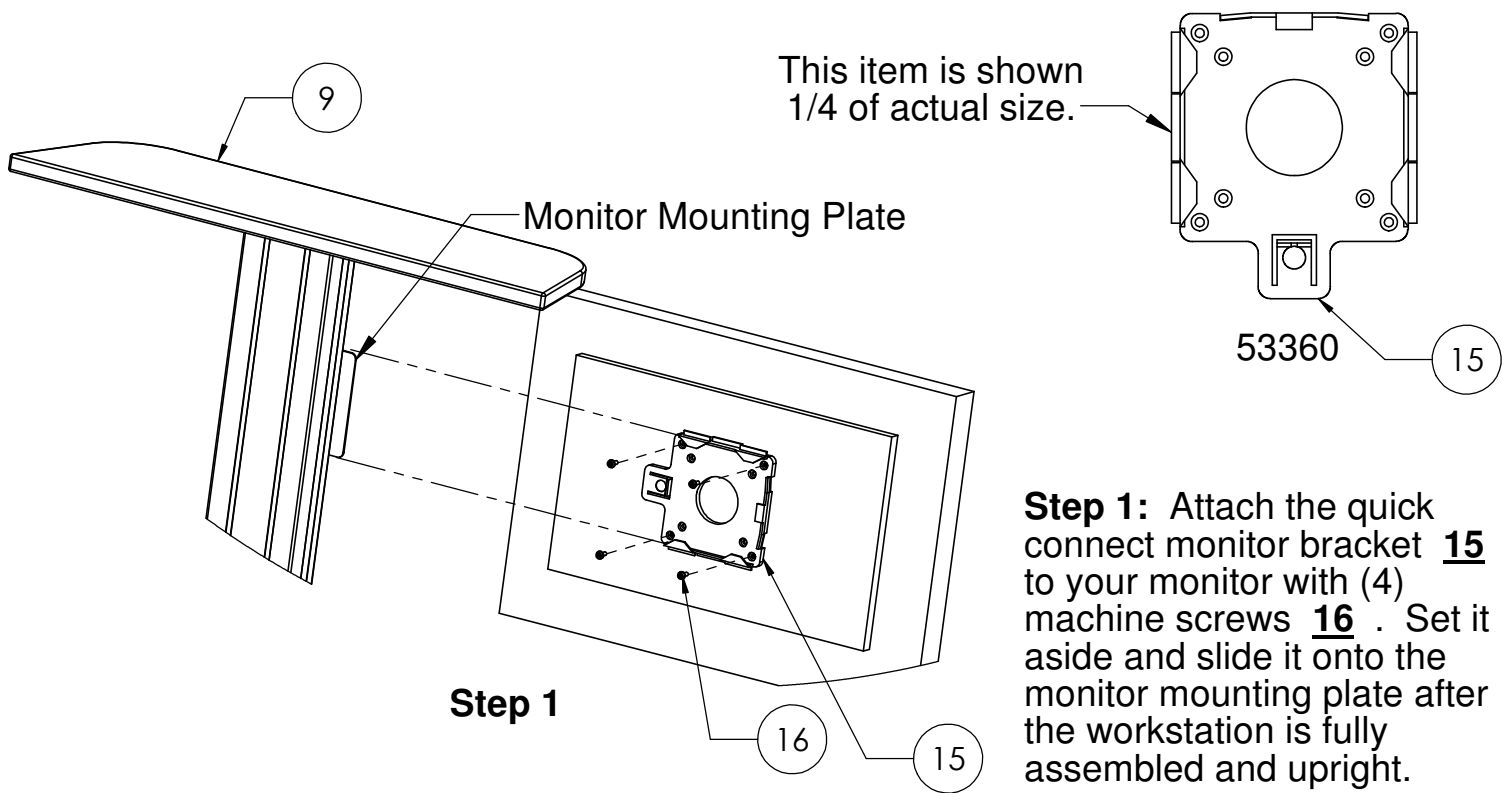

Step 1: Attach the quick connect monitor bracket **15** to your monitor with (4) machine screws **16**. Set it aside and slide it onto the monitor mounting plate after the workstation is fully assembled and upright.



K&A Manufacturing
 6703 Zinser Street Schofield, WI 54476
 Phone: 800.298.4351
 Fax: 866.882.9475
 www.raproducts.com

Step 2: Using a cordless drill and a #2 phillips head driver bit, drive (16) slim fix bolts **1** into the back panel **3** and the kick panel **4** ; (8) in each panel.

Step 3: Using a phillips screwdriver, make sure that all of the cams on the left side panel **5** and the right side panel **6** are in the open position (fully counter-clockwise).

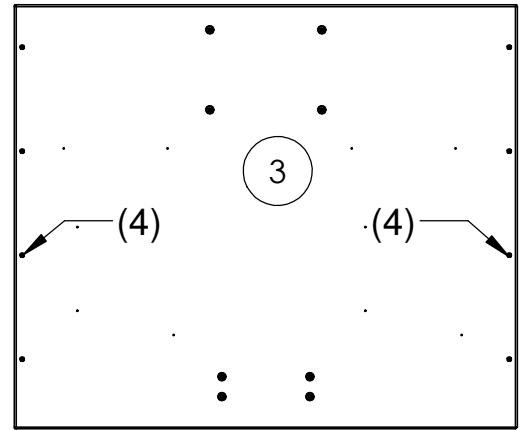
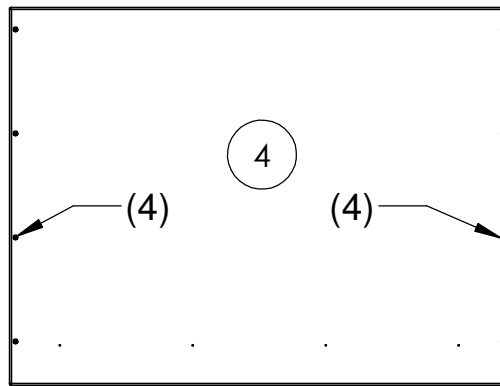
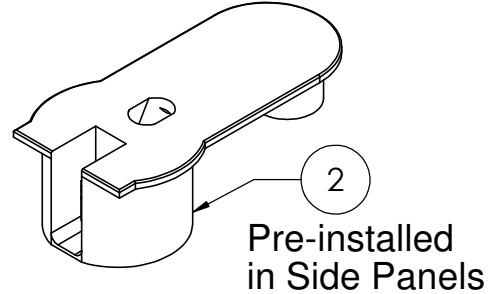
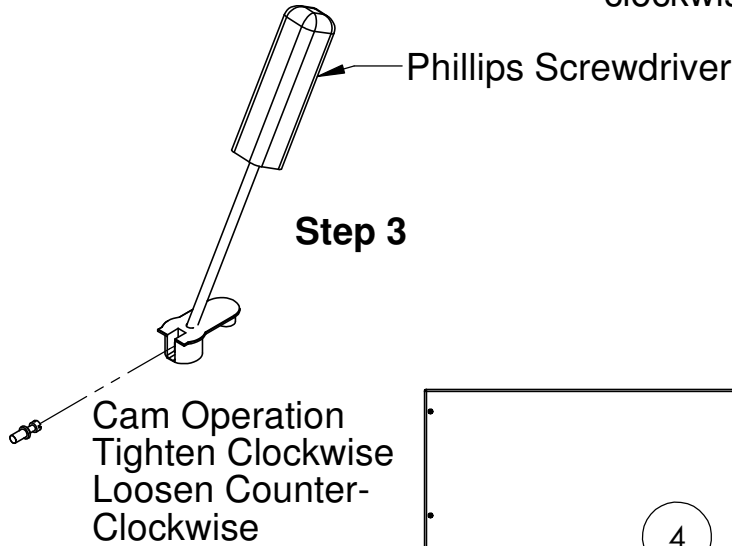

Step 2

ITEM #	PART #	DESCRIPTION	QTY.
1	51687	5mm Slim Fix Bolt	16
2	52253	19mm Rafix Connector Cam	16
3	Varies	R-STYLE HV-SERIES HOVER	1
4	Varies	HV Series 4 Kick Panel	1
5	WZRHVSPL	HV Series 4 Side Panel Left	1
6	WZRHVSPR	HV Series 4 Side Panel Right	1
7	Varies	HV Series 4 Worksurface	1
8	801298	HV Series 4 Column Assembly	1
9	WZRHVTP	HV Series 4 Top Panel	1
10	Varies	Left Leg Assembly	1
11	Varies	Right Leg Assembly	1
12	50133	10-32 x 1/2 Phillips Truss Head Machine Screw	14
13	51708	M5 x 18mm (7/8") Sq/Ph/Wshr Head Wood Screw	5
14	52406	M6-1 x 30mm Phillips Pan Head Machine Screw	6
15	53360	Quick Connect Monitor Bracket	1
16	52127	M4-7 x 10 Phillips Pan Head Machine Screw	4



K&A Manufacturing
6703 Zinser Street Schofield, WI 54476
Phone: 800.298.4351
Fax: 866.882.9475
www.raproducts.com

Step 4: Lay the column assembly **8** assembly on the back panel **3** as shown below.

Step 5: Attach the bottom plate of the column assembly **8** to the back panel **3** by screwing (4) machine screws **12** through the back of the bottom plate and into the inserts installed in the back panel. Do not fully tighten.

Step 6: Attach the side brackets to the back panel **3** with (6) machine screws **12** as you did the bottom plate. Do not fully tighten.

Step 7: Attach the top panel **9** to the worksurface support with (5) wood screws **13**. Do not fully tighten.

Step 8: Square the top panel **9** with the back panel **3** and fully tighten all the wood screws **13** holding the top panel to the worksurface support and the machine screws **12** holding the column assembly to the back panel. Set the assembly aside for installation on the workstation later.

Note: If your workstation has a mouse nest and/or a keyboard nest, attach them to the back panel using the instructions that came with them.

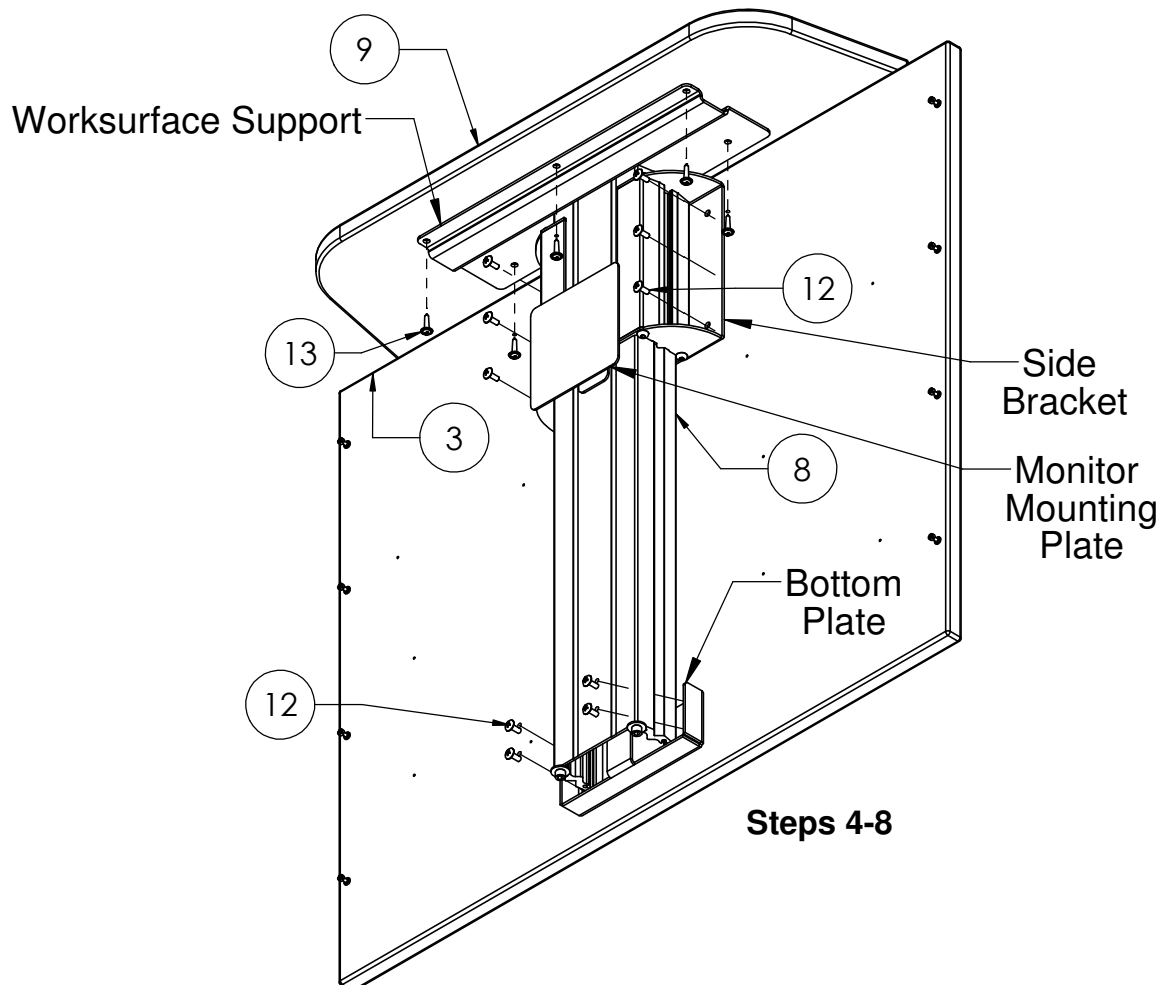



K&A Manufacturing
6703 Zinser Street Schofield, WI 54476
Phone: 800.298.4351
Fax: 866.882.9475
www.raproducts.com

Step 9: Lay the left leg assembly **10** on a protected surface with the threaded screw holes facing up. Attach the left side panel **5** to the leg assembly with (3) machine screws **14** . The long side must face the back. Do not fully tighten.

Step 10: Repeat Step **9** with the right leg assembly **11** and the right side panel **6** .

Step 11: Lay the worksurface **7** on a protected surface with the inserts facing up. Align the holes in the left leg assembly **10** worksurface support with the inserts in the worksurface. Attach the leg assembly to the worksurface with (3) machine screws **12** . Do not fully tighten.

Step 12: Repeat Step 11 with the right leg assembly **11** .

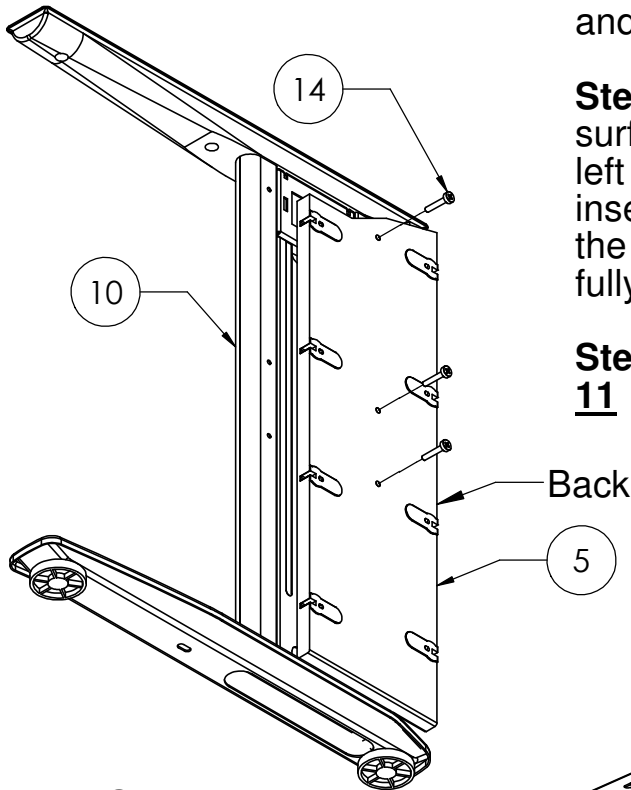

Steps 9 & 10

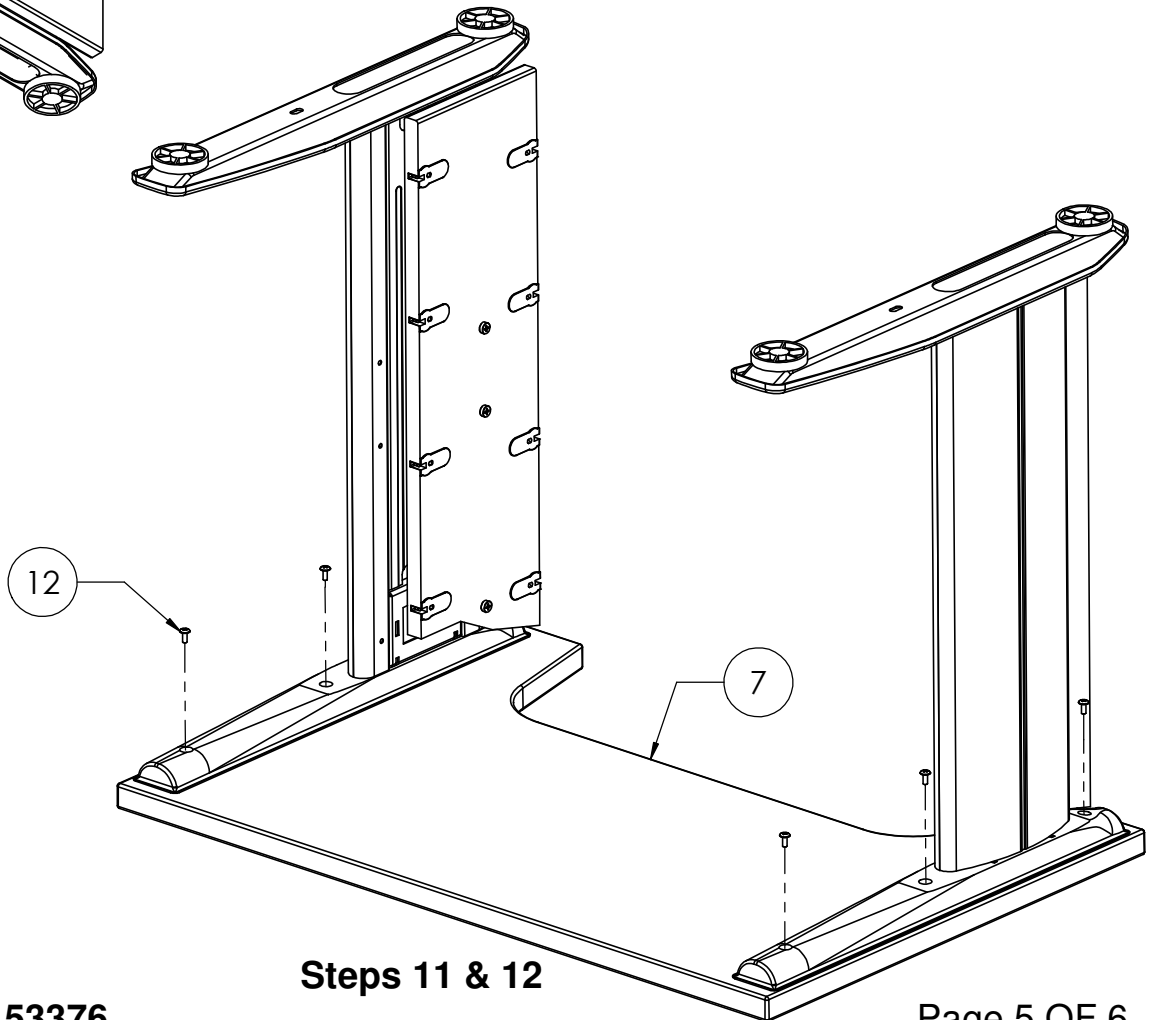

Steps 11 & 12



K&A Manufacturing
6703 Zinser Street Schofield, WI 54476
Phone: 800.298.4351
Fax: 866.882.9475
www.raproducts.com

Step 13: Insert the (8) slim fix bolts 1 in the kick panel 4 into the connector cams 2 pre-installed in the left side panel 5 and the right side panel 6. You may need to move the side panels slightly to align the bolts with the cams. Fully tighten the cam locks. **Important note:** When tightening the cams, they will stop at a detent in the mechanism before they are fully tightened. Be sure to tighten them past the detent.

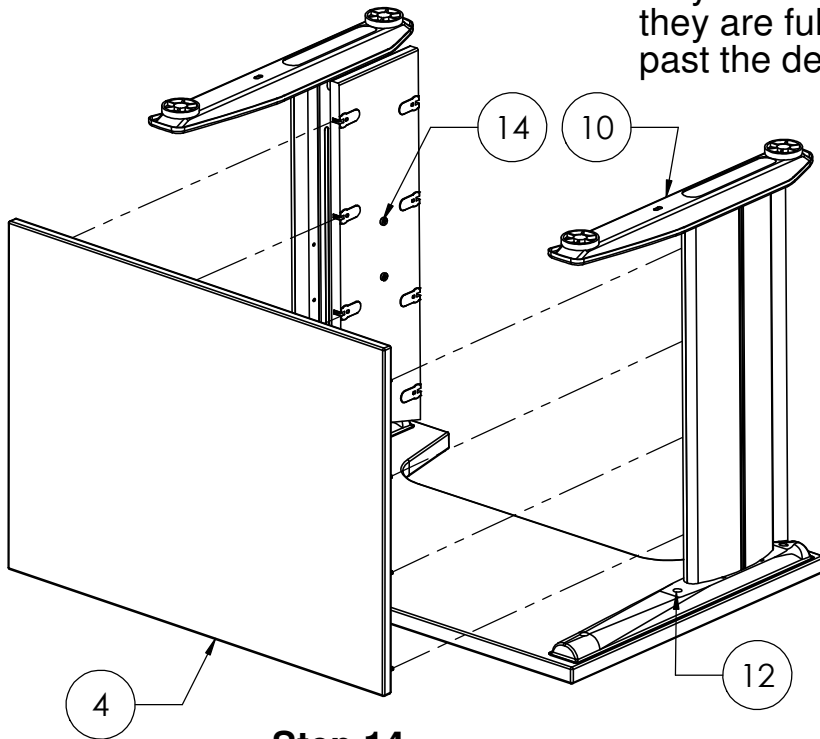

Step 14

Step 14: Insert the (8) slim fix bolts 1 in the back panel into the connector cams 2 pre-installed in the left side panel 5 and the right side panel 6. You may need to move the side panels slightly to align the bolts with the cams. Fully tighten the cam locks.

Step 15: Make sure all the panels are square and level. Fully tighten the machine screws 14 holding the side panels to the leg assemblies 10 and 11. Fully tighten the machine screws 12 holding the leg assemblies to the worksurface 7.

Step 16: With the help of an assistant, set the workstation upright in its final location. Level the workstation if required by turning the leveling glides clockwise (from the top) on the low corners of the unit. If your workstation has casters, level it by turning the bolts at the top of the casters.

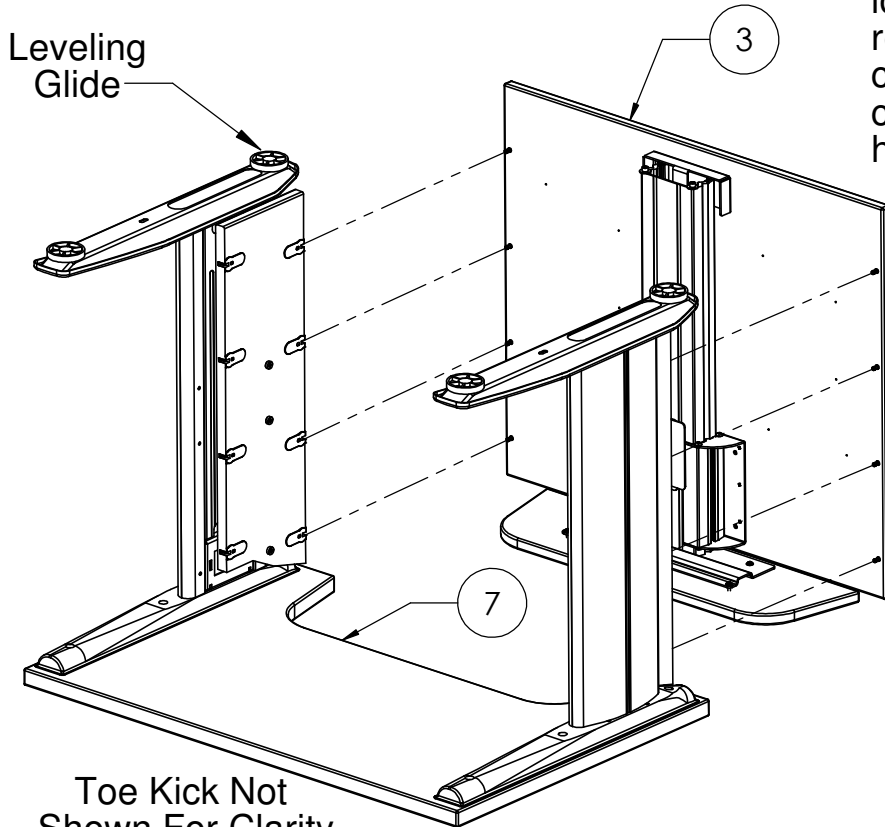

Toe Kick Not
Shown For Clarity