



ergonomic products

K&A MANUFACTURING

6703 ZINSER ST., SCHOFIELD, WI 54476

PHONE: 800.298.4351 FAX: 866.882.9475

www.raproducts.com

VERSION DATED: 9/22/10

TOOLS REQUIRED FOR ASSEMBLY:

CORDLESS DRILL
#2 PHILLIPS HEAD DRIVER BIT OR
#2 SQUARE HEAD DRIVER BIT
LEVEL

R-STYLE FLOATING LEG WORKSTATION ASSEMBLY INSTRUCTIONS:

STEP 1: LAY THE WORKSURFACE **1** ON A PROTECTED SURFACE WITH THE PILOT HOLES FACING UP.

STEP 2: ALIGN THE HOLES IN THE TOP PLATE OF A FLOATING LEG **2** WITH THE PILOT HOLES AT ONE CORNER OF THE WORKSURFACE **1**. ATTACH THE LEG TO THE WORKSURFACE WITH (5) WOOD SCREWS **4**. DO NOT OVER-TIGHTEN THE SCREWS. USE A LOW TORQUE SETTING ON THE DRILL. REPEAT **STEP 2** WITH THE OTHER (3) FLOATING LEGS.

STEP 3: U-CHANNELS ARE INCLUDED ON WORKSTATIONS 60" OR LONGER. ALIGN THE HOLES IN THE U-CANNEL **3** WITH THE PILOT HOLES AT THE CENTER OF THE WORKSURFACE **1**. ATTACH THE U-CANNEL TO THE WORKSURFACE WITH (10) WOOD SCREWS **5** ON THE 42" U-CANNEL OR (12) WOOD SCREWS ON THE 54" U-CANNEL.

STEP 4: WITH THE HELP OF AN ASSISTANT, SET THE WORKSTATION UPRIGHT AT ITS FINAL LOCATION. LEVEL THE WORKSTATION IF NECESSARY BY TURNING THE LEVELING GLIDE(S) OUT (CLOCKWISE FROM THE TOP) ON THE LOW CORNERS OF THE UNIT.

READ ALL THE INSTRUCTIONS BEFORE BEGINNING

NOTE: THE LONGER WOOD SCREWS HOLD THE LEGS ONTO THE WORKSURFACE.

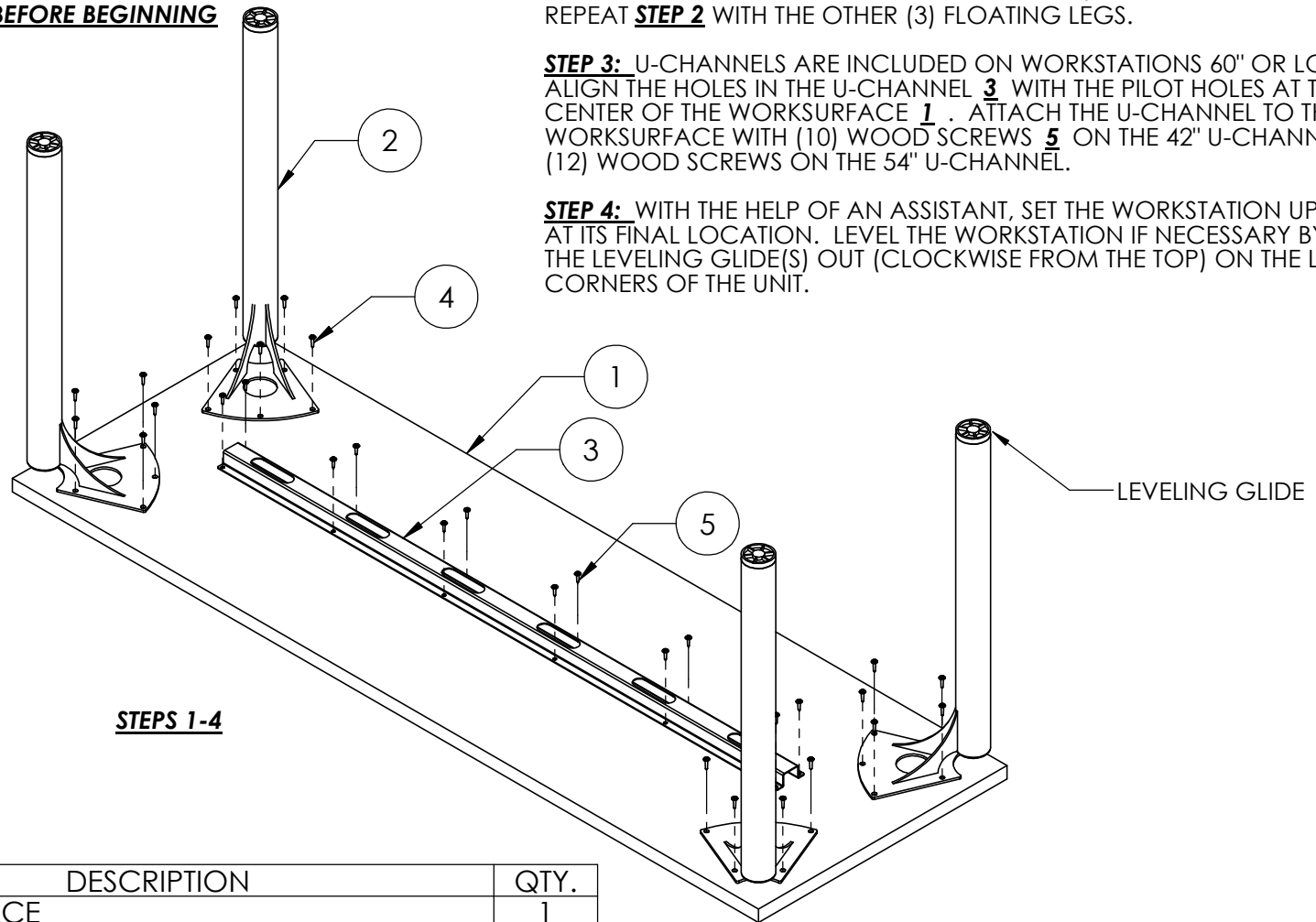

ITEM #	PART #	DESCRIPTION	QTY.
1	VARIES	WORKSURFACE	1
2	VARIES	FLOATING LEG	4
3	VARIES	42" OR 54" U-CANNEL	1
4	52488	10 x1 SQ/PH/WSHR HEAD WOOD SCREW	20
5	51708	M5 x 18mm SQ/PH/WSHR HEAD WOOD SCREW	VARIES