

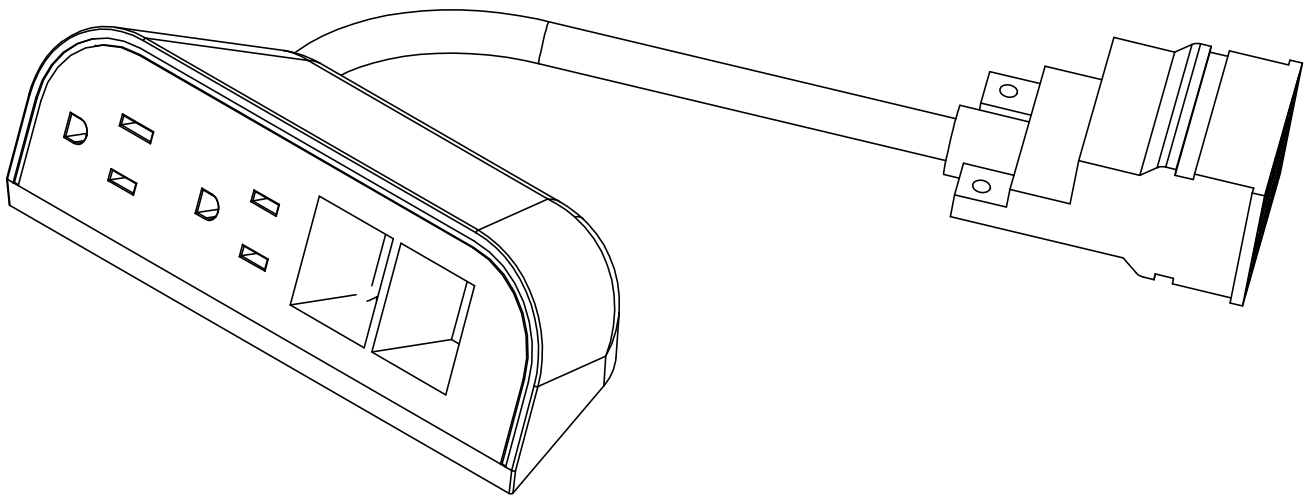

K&A Manufacturing  
6703 Zinser Street  
Schofield, WI 54476  
Phone: 800.298.4351  
Fax: 866.882.9475  
www.raproducts.com  
Version Dated: 8/26/15

## Power/Data Receptacle Installation Instructions



Read all the instructions before beginning.

**Step 1:** Remove the clamp from the PRL **1** by removing the machine screw **2** that holds it in place. Insert a flat blade screwdriver between the bottom plate and the body of the PRL and gently pry up the bottom plate. Pull the clamp out from the body. Save the screw and discard the clamp.

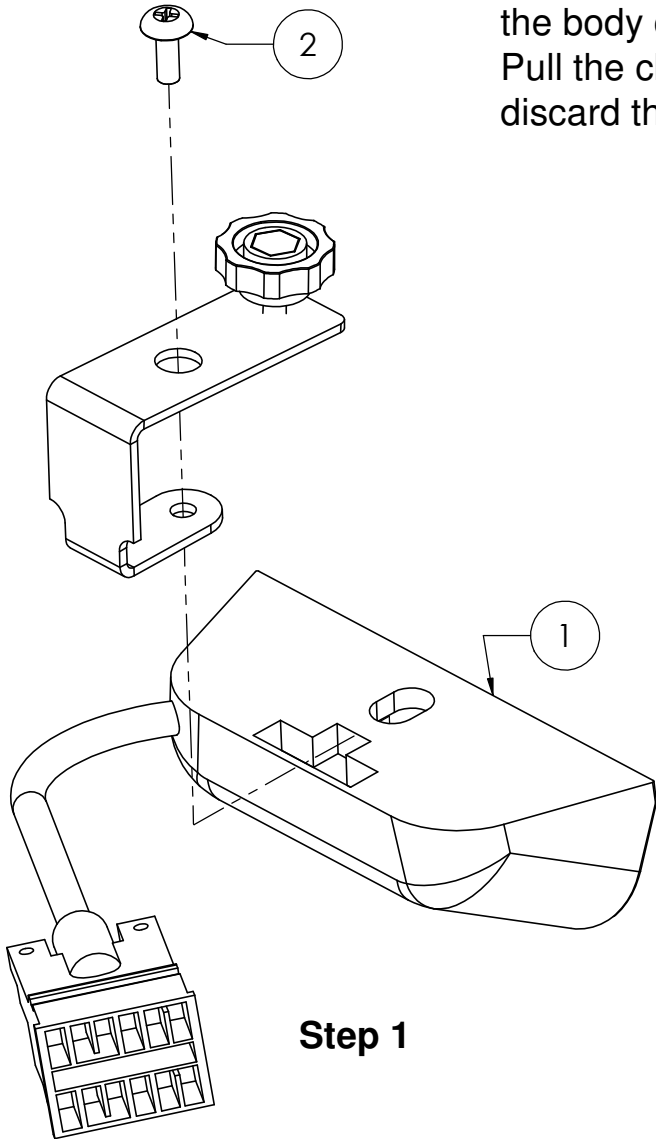

**Step 1**

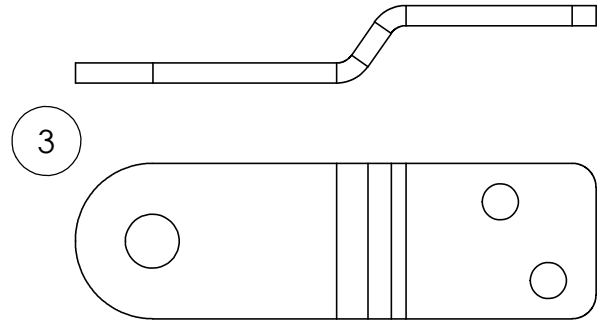

800719

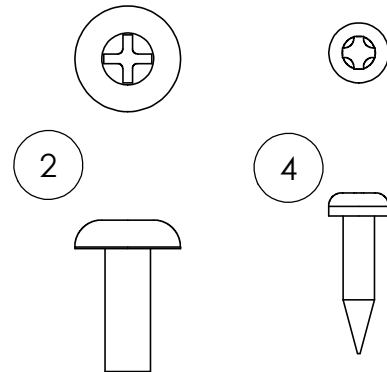

Existing Screw

50072

**Hardware Is Drawn Actual Size**

ITEM #	PART #	DESCRIPTION	QTY.
1	PRL	Surface Mount Power/Data Receptacle	1
2	Use Existing	1/4-20 x 5/8 Phillips Truss Head Machine Screw	1
3	800719	PRLB (Power Management) Bracket	1
4	50072	8 x 3/4 Phillips Pan Head Recex Drive Screw	2

**Step 2:** Insert the PRLB bracket **3** into the seat on the bottom plate. Attach it using the screw that held the clamp in place. Orient the bracket as shown at the left.

**Step 3:** Place the receptacle at the desired location and attach it with (2) recex drive screws **4**. Do not over-tighten the screws. Use a low torque setting on the power driver.

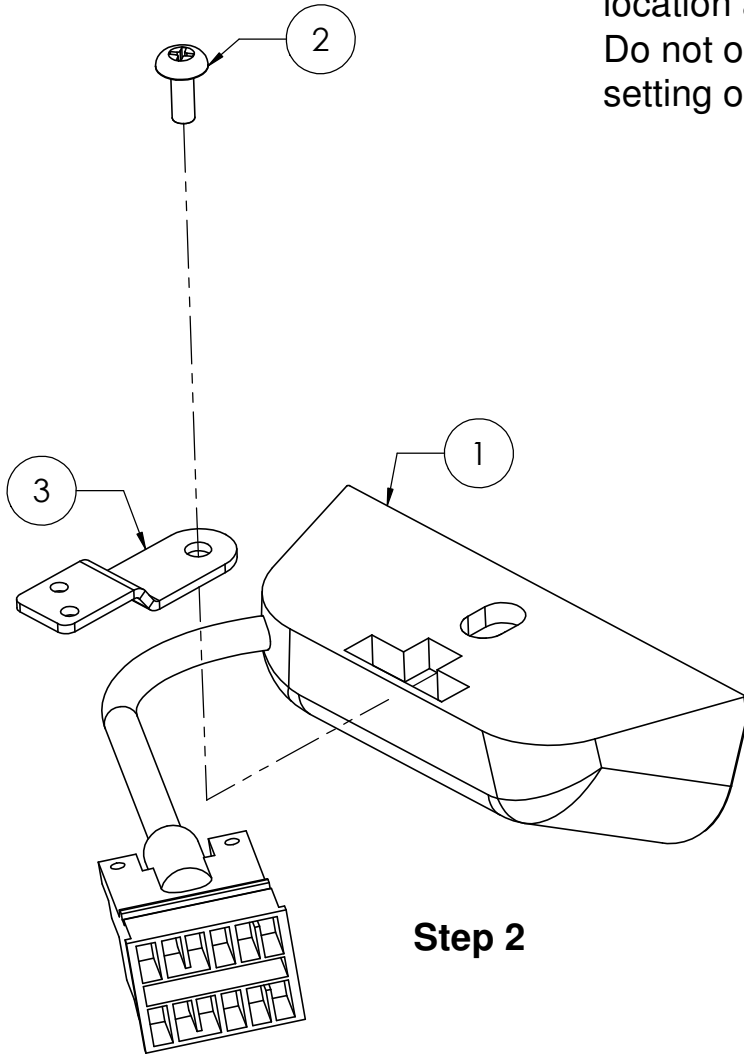

**Step 2**

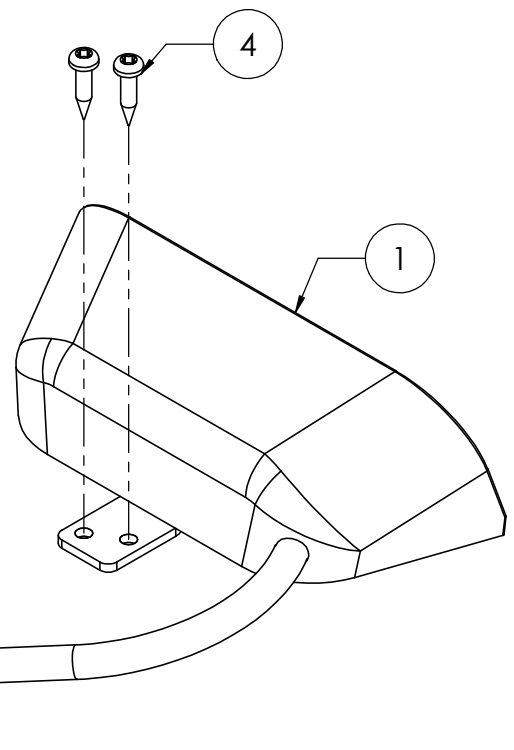

**Step 3**