

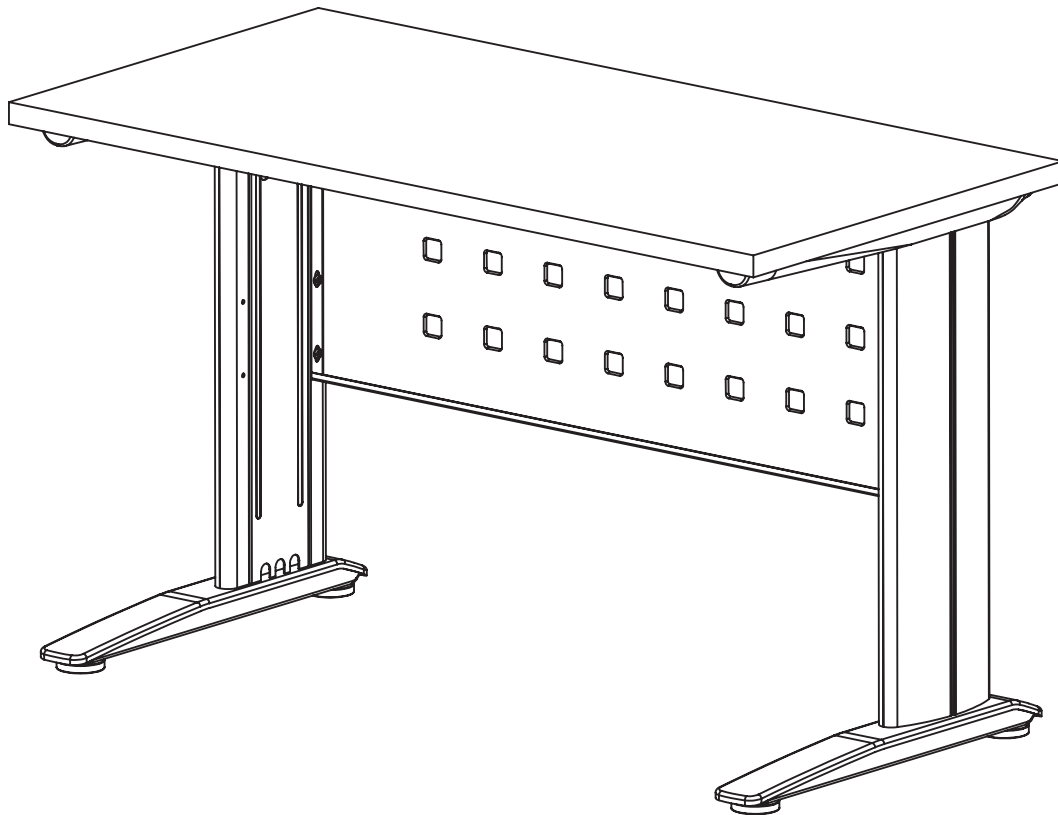

## R-Style Modesty Panel Instructions (RCM)

Warranty: [raproducts.com/warranty](http://raproducts.com/warranty)



---

## R-Style Beam Assembly Instructions (RCB): *Pages 4 - 6*

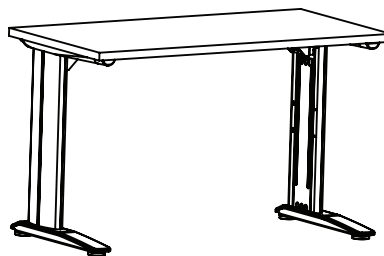

## Tools Required for Assembly

R-Style Modesty Panel & Beam #53357

- A. Power Driver with Adjustable Torque
- B. #2 Phillips Head Driver Bit
- C. #2 Square Head Drive Bit

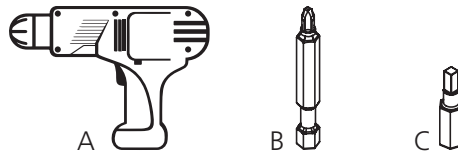

## Hardware Included for Assembly *(may have extra)*

- D. M6 x 1/2" Phillips Machine Screw x6
- E. 10 X 5/8" Round Washer Head Recex Drive Screw x9



## Step 1

- Attach the modesty panel to the legs with six machine screws.

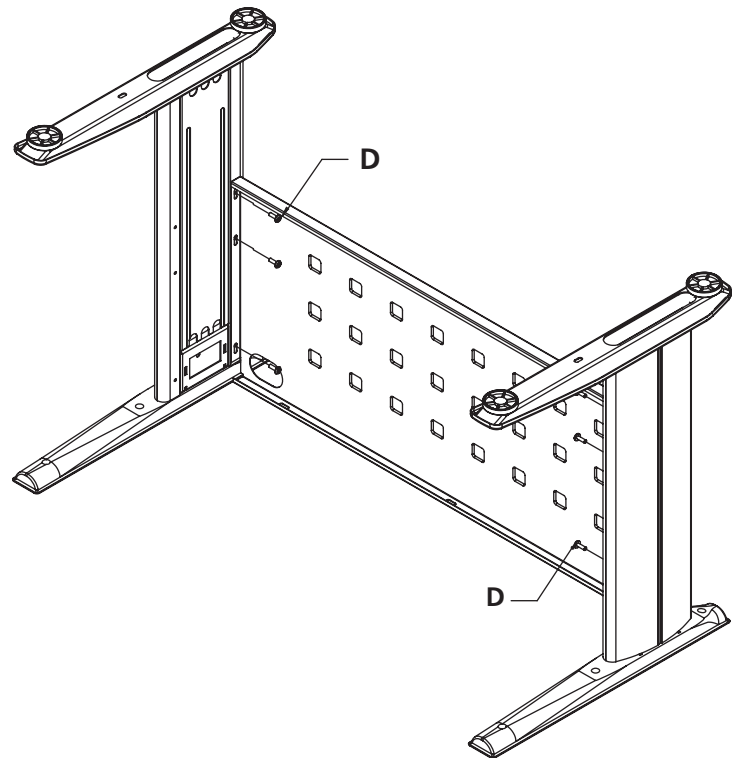
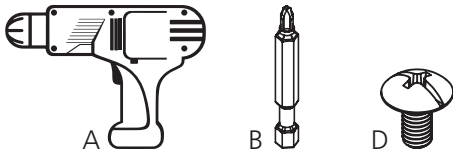

## Step 2

- Attach the modesty panel and legs to the worksurface with the wood screws.

**Note:** there are no pilot holes in the worksurface for the modesty panel attachment. Predrilling is not required.

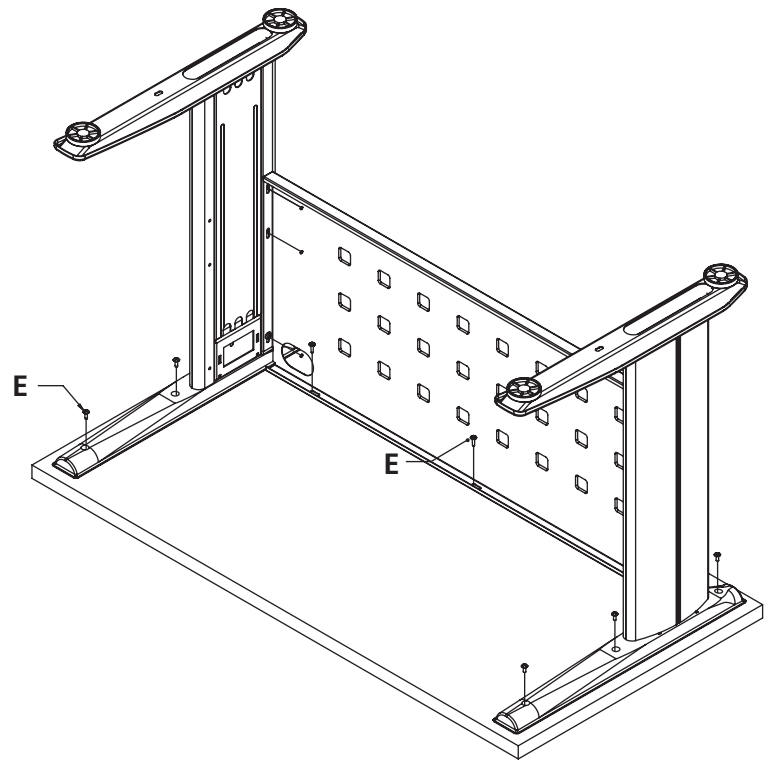
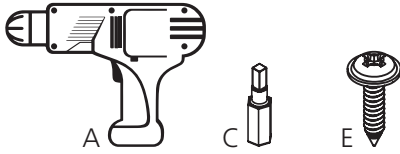

**If you have optional threaded inserts in your worksurface, refer to the insert instruction #54134.**



## R-Style Beam Assembly Instructions (RCB)

Warranty: [raproducts.com/warranty](http://raproducts.com/warranty)

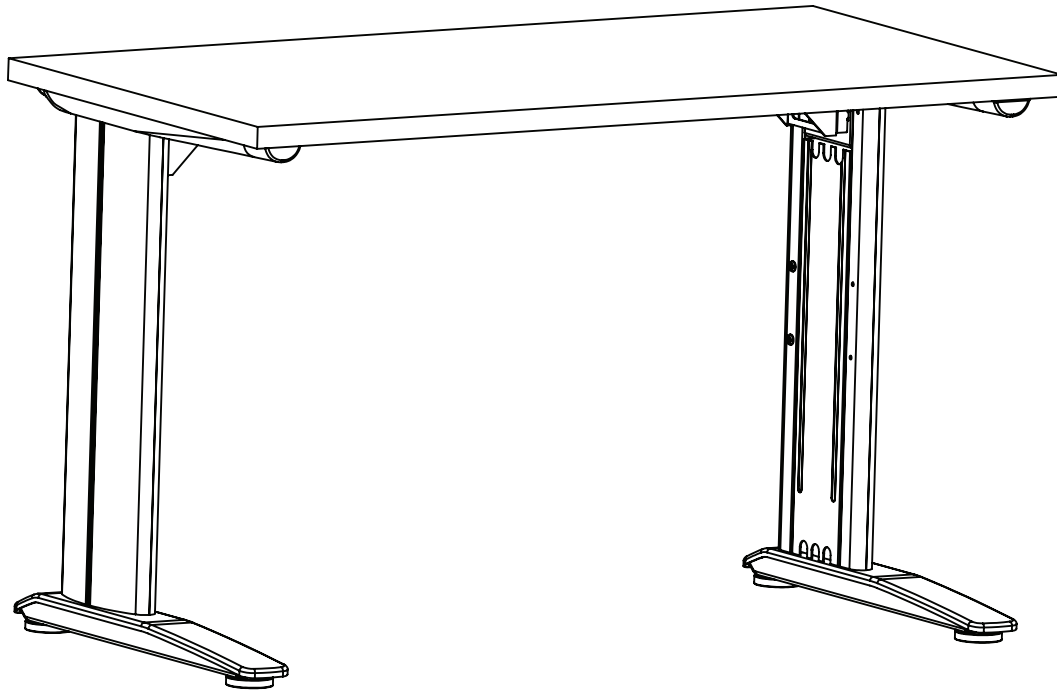

---

## R-Style Modesty Panel Instructions (RCM): *Pages 1 - 3*

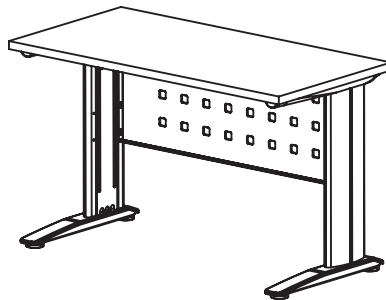

## Tools Required for Assembly

R-Style Modesty Panel & Beam #53357

- A. Power Driver with Adjustable Torque
- B. #2 Phillips Head Driver Bit
- C. #2 Square Head Drive Bit
- D. Level

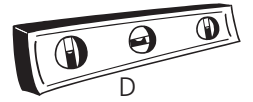
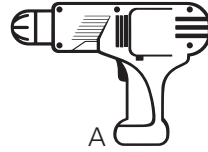

## Hardware Included for Assembly (may have extra)

- E. M6 x 1/2" Machine Screw x4
- F. 10 x 5/8" Round Washer Wood Screw x6
- G. 3/16" x 3/4" Wood Screw x3
- H. M6 x 9/16" Black Machine Screw x2
- I. 5/64" x 1 3/8" Plate x2

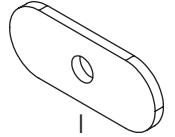
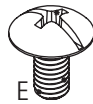

## Step 1

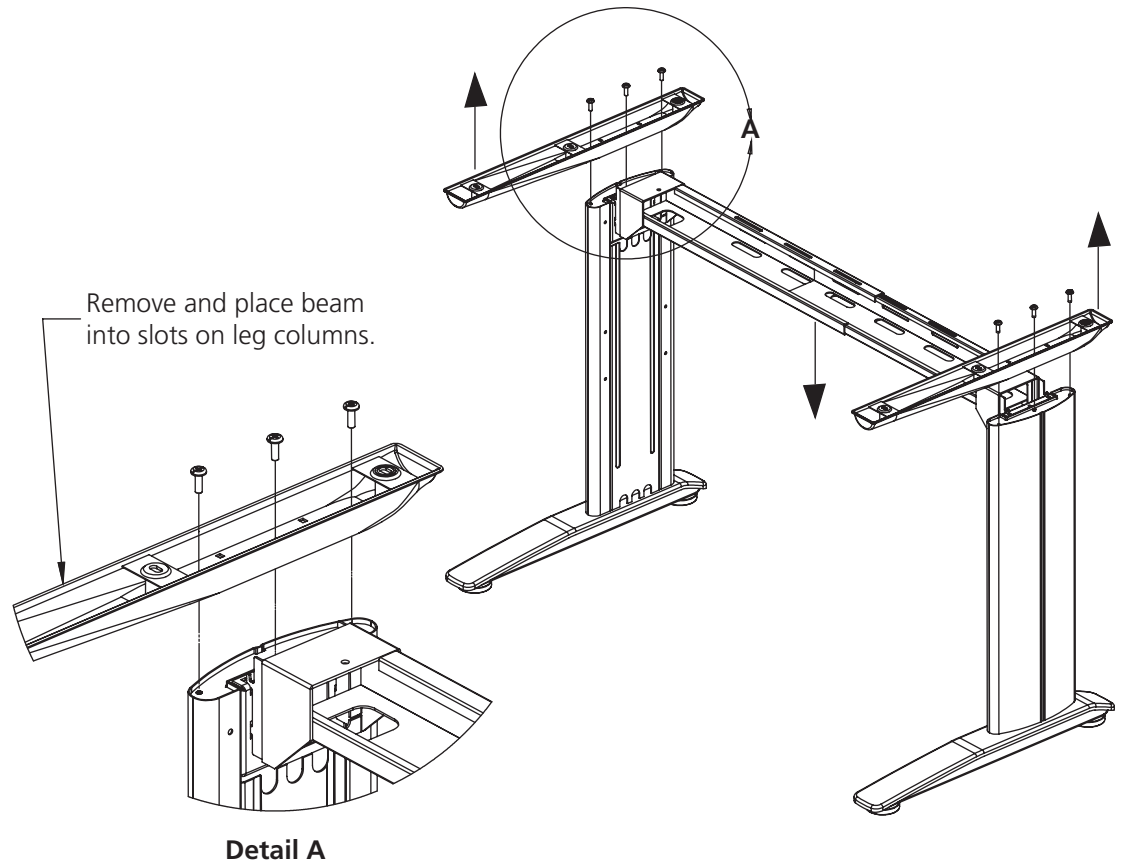
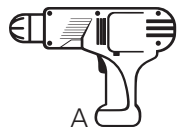

## Step 2

- Install wood screws.
- Install machine screws and plate for final adjustment.

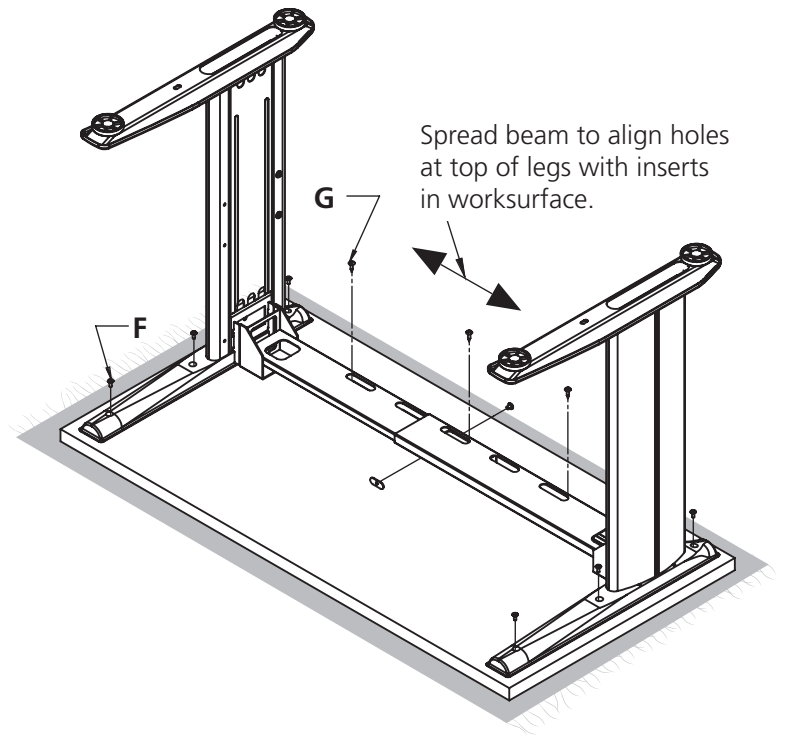
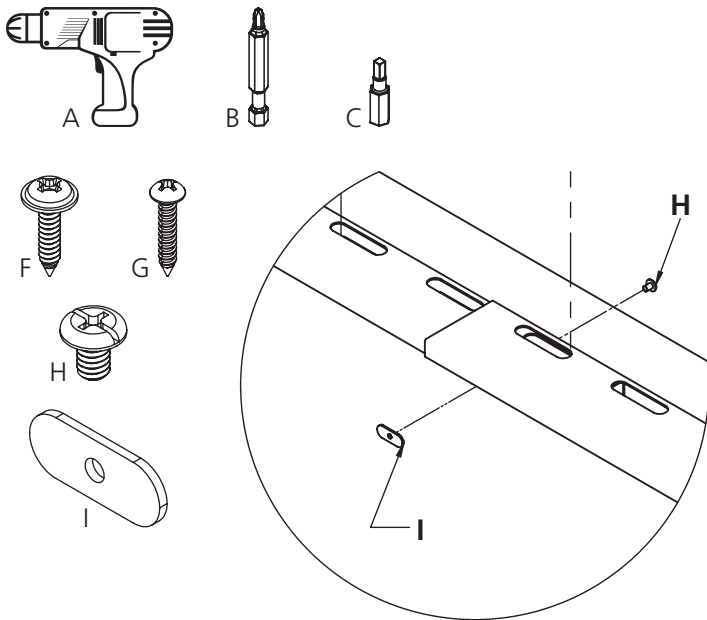

## Step 3 Optional Stability Panel

- Install the machine screws into the legs and panel hardware.

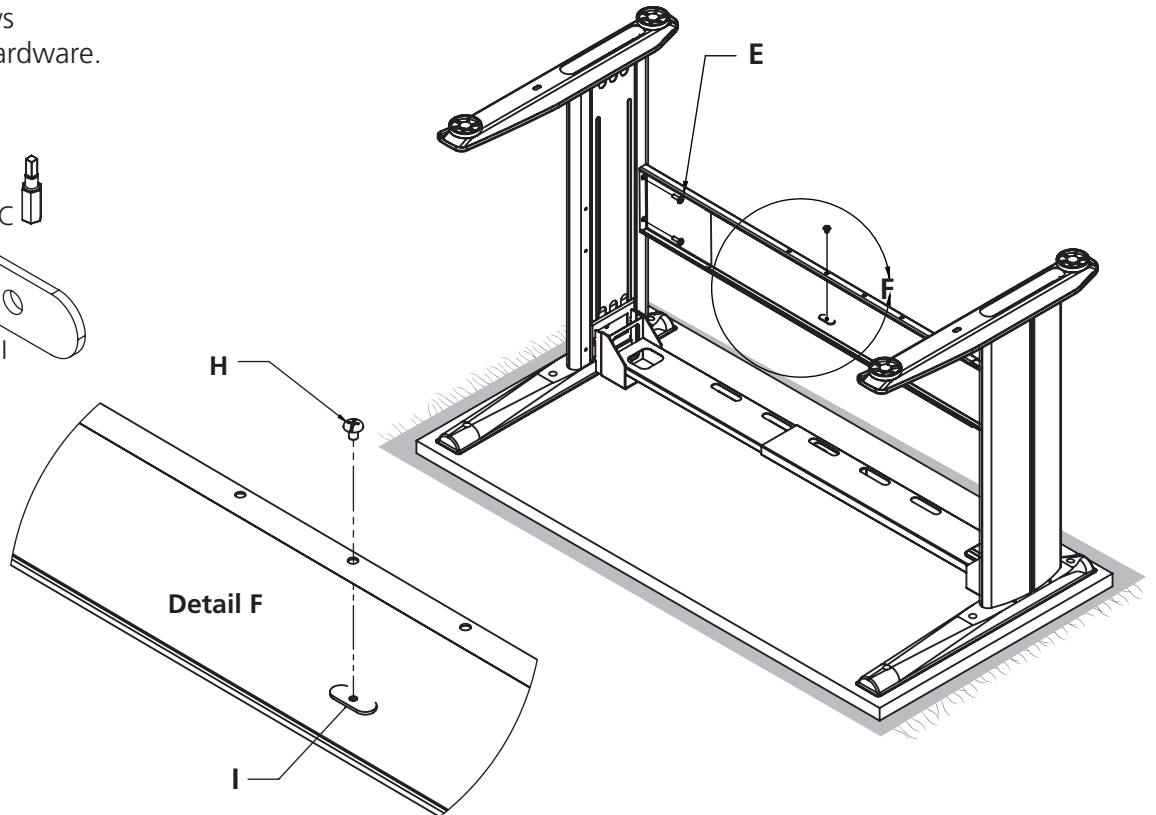
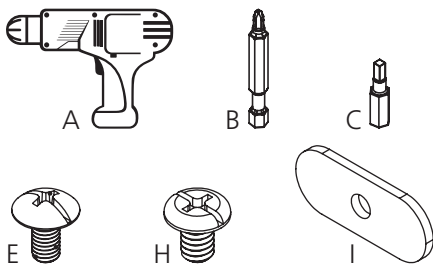

**If you have optional threaded inserts in your worksurface, refer to the insert instruction #54134.**