



ergonomic products

K&A MANUFACTURING

6703 ZINSER ST., SCHOFIELD, WI 54476
 PHONE: 800.298.4351 FAX: 866.882.9475
 www.rapproducts.com

VERSION DATED: 11/21/11

TOOLS REQUIRED FOR ASSEMBLY:

- CORDLESS DRILL
- #2 PHILLIPS HEAD DRIVER BIT
- NEEDLE NOSED PLIERS

READ ALL THE INSTRUCTIONS BEFORE BEGINNING

NewGas WORKSTATION INSTRUCTIONS FOR REPLACING THE CABLE PADDLE AND RELEASE:

STEP 1: WITH THE HELP OF AN ASSISTANT, LAY THE WORKSTATION UPSIDE DOWN ON A PROTECTED SURFACE. REMOVE THE (8) WOOD SCREWS **6** HOLDING THE WORKSURFACE **2** TO THE WORKSURFACE SUPPORT **5** AND DISCARD THEM.

STEP 2: REMOVE THE (2) SELF DRILLING SCREWS **7** HOLDING THE CABLE CLAMPS **8** TO THE WORKSURFACE SUPPORT **5** AND DISCARD THE CLAMPS AND SCREWS. REMOVE THE (4) RECEX DRIVE SCREWS **4** HOLDING THE CABLE RELEASE PADDLE **3** TO THE WORKSURFACE **2** AND DISCARD THEM.

STEP 3: WITH THE HELP OF AN ASSISTANT, SET THE COLUMN AND LEG ASSEMBLY UPRIGHT. REMOVE THE O-RING **9** HOLDING THE CABLE AND CABLE STOP ONTO THE RELEASE MECHANISM ON THE INSIDE OF THE WORKSURFACE SUPPORT **5**. SEE THE PICTURE BELOW. USING A NEEDLE NOSED PLIERS, SQUEEZE THE FLANGES HOLDING THE RELEASE CABLE AND PULL THE CABLE OUT OF THE WORKSURFACE SUPPORT. DISCARD THE EXISTING CABLE PADDLE RELEASE ASSEMBLY **3** AND THE O-RING.

PADDLE REPLACEMENT PARTS			
ITEM #	PART #	DESCRIPTION	QTY.
10	52695	NewGas CONTROL PADDLE W/CABLE	1
11	52298	RUBBER O-RING	1
12	52604	3/16" CABLE CLAMP	2
13	52488	10x1 SQ/PH/WSHR HEAD WOOD SCREW	10
14	50336	8-18x1/2 PHIL. PAN SELF DRILL SCREW	2
15	50183	6mm ID x 12.5mm OD x.6mm TH WASHER	2

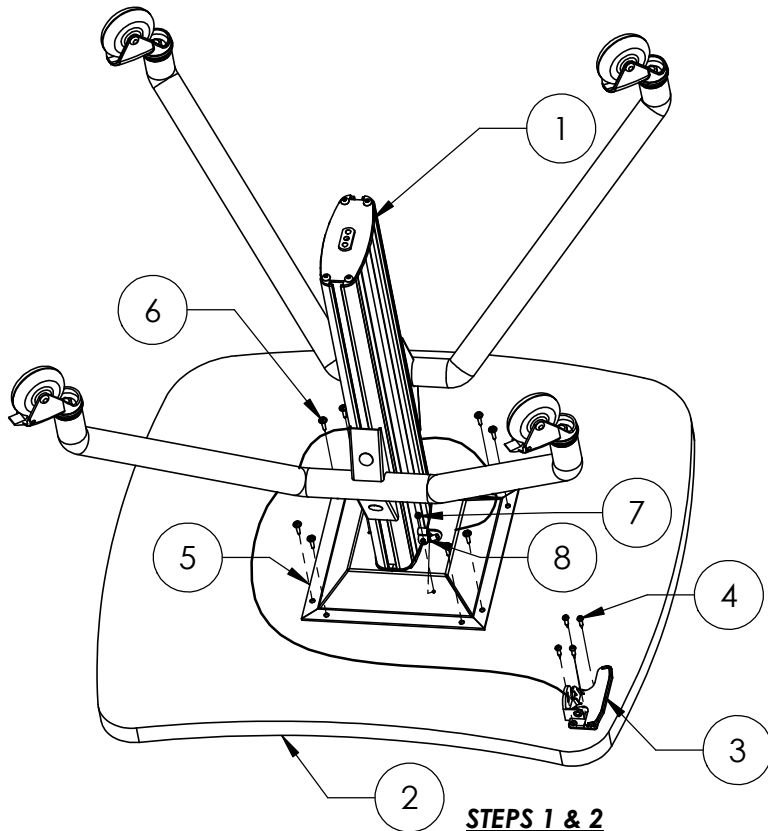
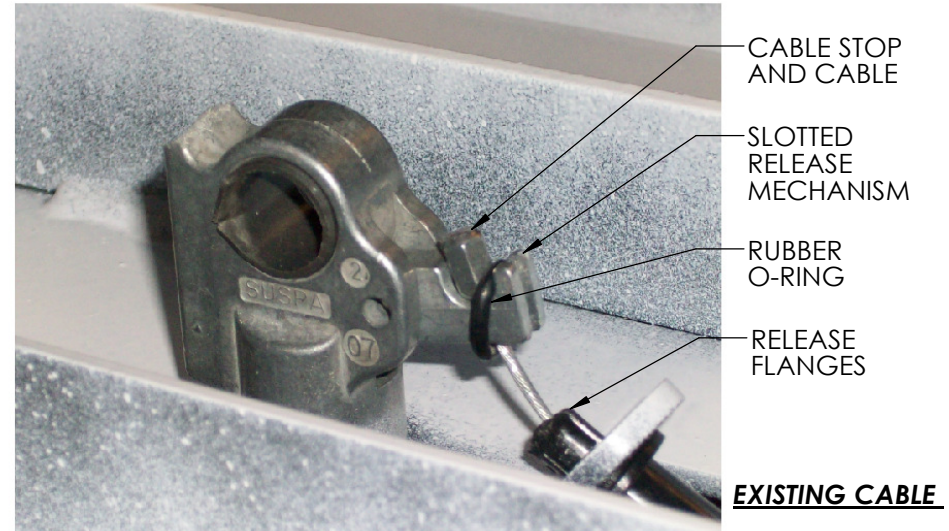

STEPS 1 & 2

ITEM #	PART #	DESCRIPTION	QTY.
1	VARIES	NewGas COLUMN ASSY	1
2	VARIES	NewGas WORKSURFACE	1
3	51919	NewGas CONTROL PADDLE W/CABLE (EXISTING)	
4	50072	8 x 3/4 PHILLIPS PAN HEAD RECEX DRIVE SCREW	4
5	800189	NewGas TABLE WORKSURFACE SUPPORT	1
6	51708	M5 x 18mm SQ/PH/WSHR HEAD WOOD SCREW	8
7	50336	8-18X1/2 PHIL. PAN SELF DRILL SCREW	2
8	52604	3/16" CABLE CLAMP (EXISTING)	2
9	52298	RUBBER O-RING (EXISTING)	1



ergonomic products

K&A MANUFACTURING

6703 ZINSER ST., SCHOFIELD, WI 54476

PHONE: 800.298.4351 FAX: 866.882.9475

www.raproducts.com

VERSION DATED: 11/21/11

STEP 4: REFER TO THE INSIDE VIEW OF THE WORKSURFACE SUPPORT **5** BELOW. INSERT THE THREADED END OF THE CABLE AND PADDLE ASSEMBLY **10** INTO THE HOLE IN THE TAB AT THE BOTTOM OF THE WORKSURFACE SUPPORT **5** FROM THE BOTTOM UP. PLACE (2) WASHERS **15** OVER THE CABLE AND CABLE STOP. INSERT THE CABLE STOP THROUGH THE NUT; THREAD THE NUT ONTO THE END OF THE ASSEMBLY AND TIGHTEN.

STEP 5: PLACE THE NEW O-RING **11** OVER THE CABLE STOP AT THE END OF THE RELEASE CABLE. PLACE THE CABLE INTO THE SLOT AT THE RELEASE MECHANISM AND PULL THE O-RING OVER THE SLOTTED MECHANISM SO IT HOLDS THE CABLE IN THE SLOT. THE O-RING MUST BE BEHIND THE CABLE AT THE BOTTOM OF THE SLOT AND IN FRONT OF THE STOP AT THE TOP OF THE SLOT. REFER TO THE PICTURE ON PAGE 1 OF 2. RE-ATTACH THE COLUMN **1** TO THE WORKSURFACE **5** USING (8) OF THE NEW WOOD SCREWS **13** PROVIDED WITH THE NEW PADDLE RELEASE **10**. DO NOT OVER-TIGHTEN THE SCREWS. USE A LOW TORQUE SETTING ON THE DRILL.

STEP 6: INSERT THE CABLE INTO THE NEW CLAMPS **12** PROVIDED. WRAP THE CABLE AROUND THE BACK OF THE COLUMN **1** AS SHOWN. SECURE THE NEW PADDLE **10** TO THE WORKSURFACE **2** WITH THE REMAINING (2) NEW WOOD SCREWS **13** PROVIDED WITH THE NEW PADDLE RELEASE. YOU MAY NEED TO DRILL NEW PILOT HOLES.

STEP 7: ATTACH THE NEW CABLE CLAMPS **12** TO THE WORKSURFACE SUPPORT **5** USING THE NEW SCREWS **14**. MAKE SURE THERE IS ENOUGH SLACK IN THE CABLE TO ALLOW IT TO COME STRAIGHT OUT OF THE WORKSURFACE SUPPORT. SET THE WORKSTATION UPRIGHT. IT IS NOW READY FOR OPERATION.

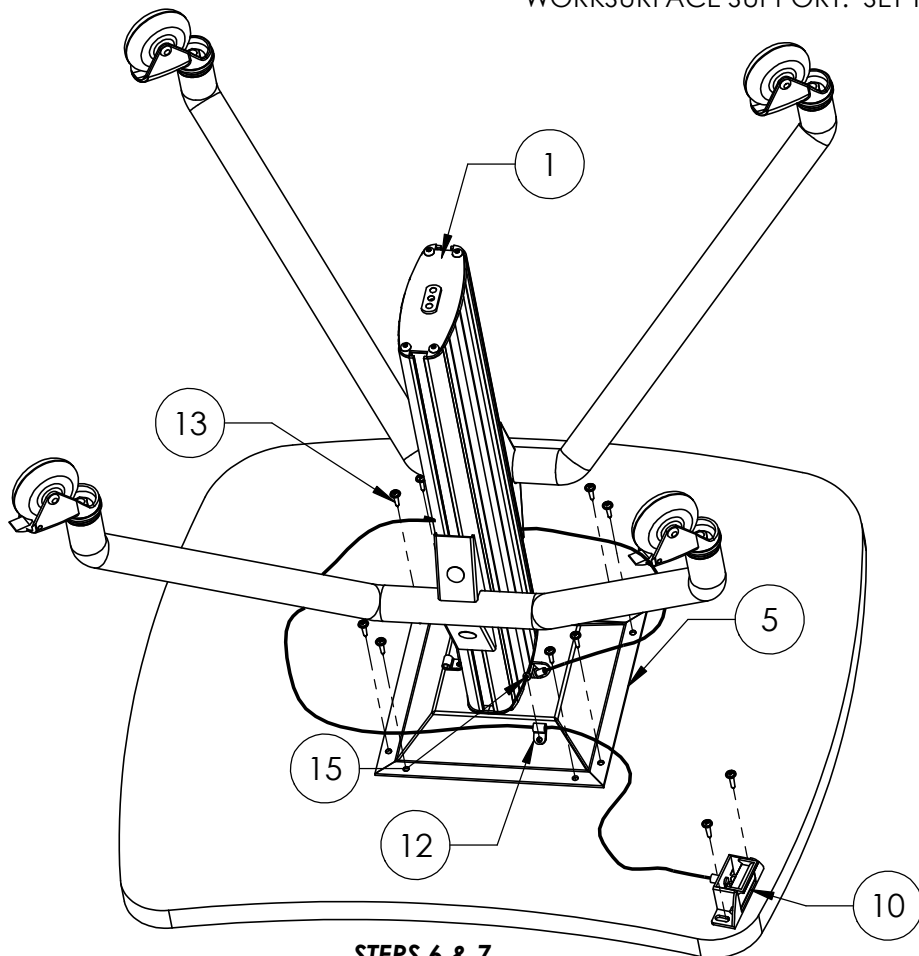

STEPS 6 & 7

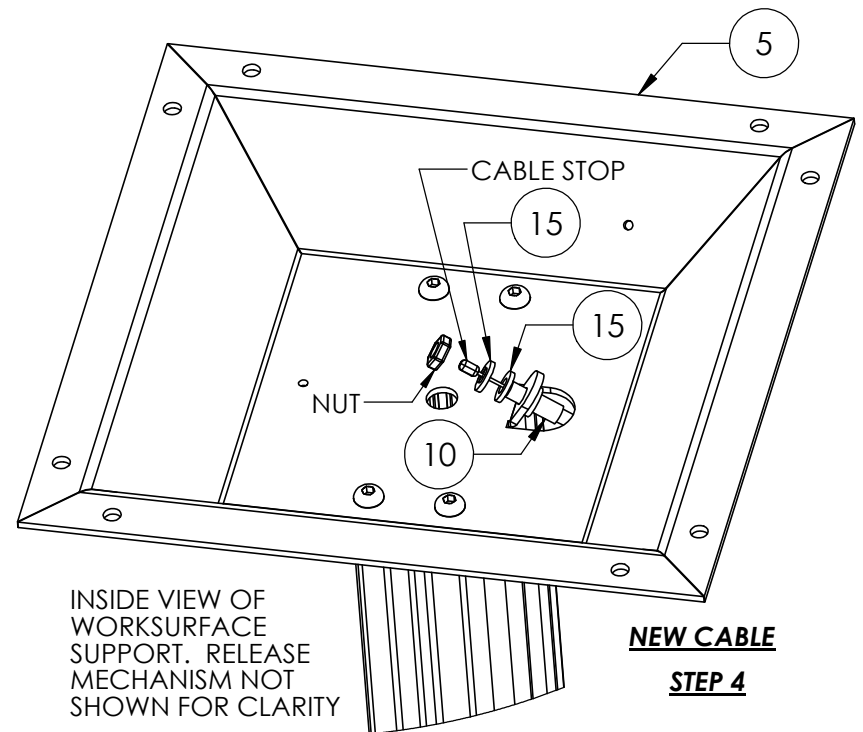

INSIDE VIEW OF WORKSURFACE SUPPORT. RELEASE MECHANISM NOT SHOWN FOR CLARITY

NEW CABLE
STEP 4