



ergonomic products

K&A MANUFACTURING

6703 ZINSER ST., SCHOFIELD, WI 54476
PHONE: 800.298.4351 FAX: 866.882.9475
www.raproducts.com

VERSION DATED: 11/8/11

TOOLS REQUIRED FOR ASSEMBLY:

- FLAT BLADED SCREWDRIVER
- NEEDLE NOSED PLIERS
- 17mm OR 11/16" COMBINATION WRENCH
- 9/16" COMBINATION WRENCH
- 1/2" COMBINATION WRENCH

NewGas AND VerSit INSTRUCTIONS TO REPLACE THE CASTERS ON THE TABLE AND SHIM THE CASTERS ON THE SEAT BASE:

STEP 1: WITH THE HELP OF AN ASSISTANT, LAY THE NewGas TABLE ON ITS BACK OR SIDE ON A PROTECTED SURFACE. IF YOU PLACE IT ON ITS BACK, REMOVE THE KEY FROM THE LOCK BOX (IF SO EQUIPPED) TO PREVENT IT FROM BENDING OR BREAKING.

STEP 2: REMOVE THE (4) CASTERS FROM THE WORKSTATION WITH A FLAT BLADED SCREWDRIVER OR A NEEDLE NOSED PLIERS. SEE PICTURES # 1 AND # 2. DISCARD THE CASTERS.

STEP 3: REMOVE THE THREADED STEMS AT THE BOTTOM OF THE LEGS USING A 17mm OR 11/16" COMBINATION WRENCH. REMOVE THE STEMS AND DISCARD THEM. IF THE STEMS JUST SPIN AND CAN NOT BE REMOVED, CONTACT DENYSE GIBSON IN CUSTOMER SERVICE; EXTENSION 101 AT THE NUMBER SHOWN AT THE LEFT FOR FURTHER OPTIONS.

STEP 4: VERIFY THAT THE THREADED METAL INSERTS IN THE BOTTOM OF THE LEGS ARE GOLD IN COLOR. IF THE PARTS ARE NOT GOLD, CONTACT DENYSE FOR REPLACEMENT INSERTS. SEE PICTURE #3.

STEP 5: ATTACH THE NEW CASTERS **6** AND **7** BY THREADING THEM INTO THE INSERTS. TIGHTEN WITH A 9/16" COMBINATION WRENCH. SEE PICTURE # 4. INSTALL THE LOCKING CASTERS ON THE FRONT LEGS (SEAT SIDE WITH THE VerSit). INSTALL THE NON-LOCKING CASTERS ON THE BACK LEGS.

STEP 6: REMOVE THE (3) SEAT BASE CASTERS WITH A FLAT SCREWDRIVER OR A NEEDLE NOSED PLIERS. SEE PICTURES # 1 AND # 2. SAVE THE CASTERS FOR RE-INSTALLATION LATER.

STEP 7: REMOVE THE (3) STEMS FROM THE THREADED INSERTS USING A 1/2" COMBINATION WRENCH. DISCARD THE STEMS.



PICTURE # 1

STEPS 1, 2, & 6



PICTURE # 2

STEPS 1, 2, & 6

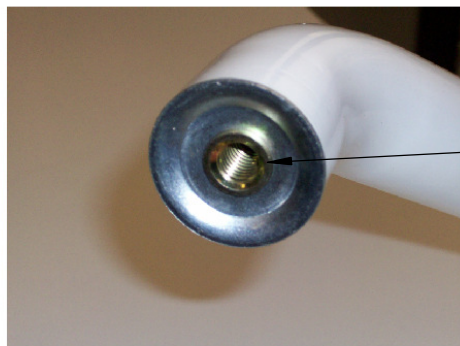

—THREADED PART SHOULD BE GOLD IN COLOR

STEPS 3 & 4

PICTURE # 3



STEP 5

PICTURE # 4

STEP 8: PLACE A BLACK PLASTIC WASHER **4** WITH THE DRILLED RECESS ON THE THREADED END ON ONE OF THE (3) REPLACEMENT STEMS **5**. THE RECESS MUST FACE THE CASTER **2**. PLACE ANOTHER BLACK PLASTIC WASHER **4** (WITHOUT THE RECESS) ON THE STEM AGAINST THE FIRST WASHER. THREAD THE STEM AND WASHER ASSEMBLY INTO ONE OF THE CASTER INSERTS **1** AND TIGHTEN USING A 1/2" COMBINATION WRENCH. REPEAT WITH THE OTHER (2) STEM AND WASHER ASSEMBLIES.

STEP 9: PLACE THE CASTERS **2** ON THE STEMS **5**. THEY SHOULD SNAP INTO PLACE. TAP THE BOTTOMS WITH A RUBBER Mallet IF NECESSARY. SEE PICTURE # 5.

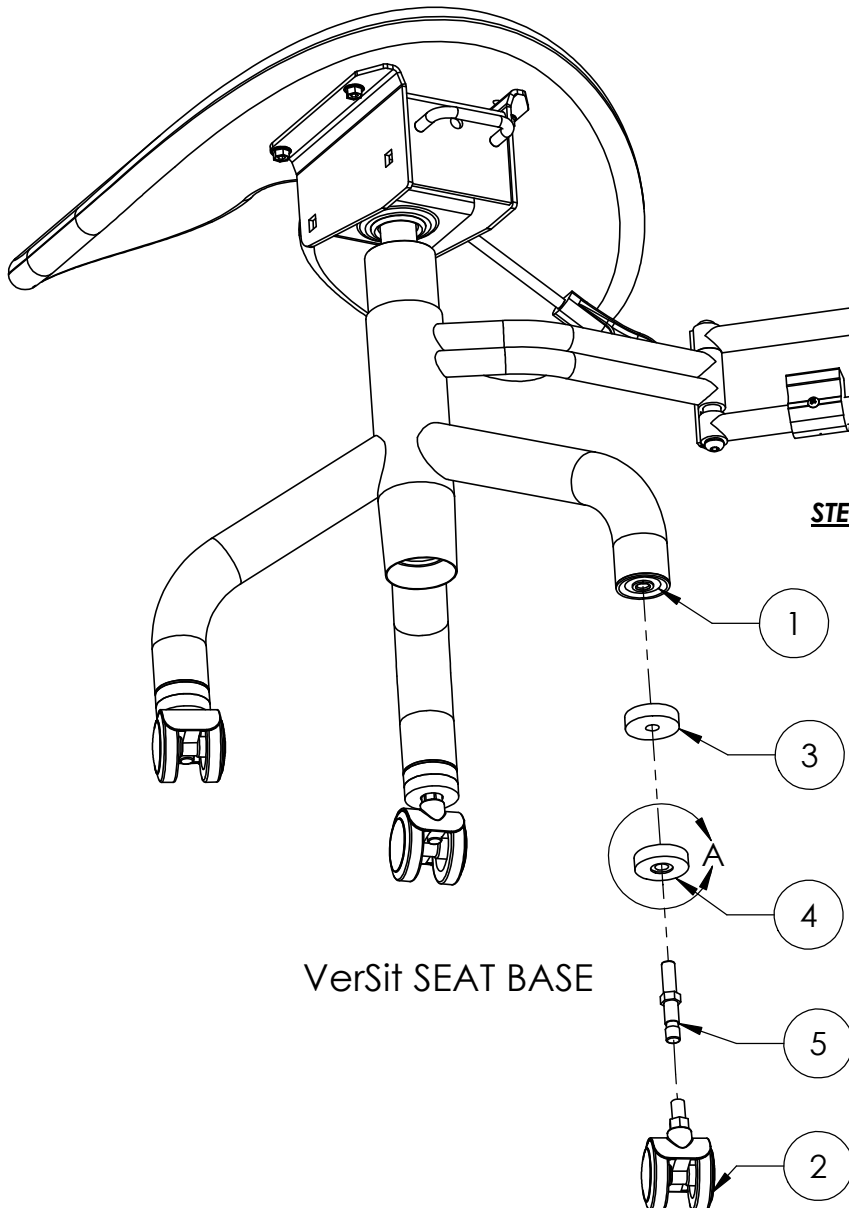

VerSit SEAT BASE

STEPS 8 & 9

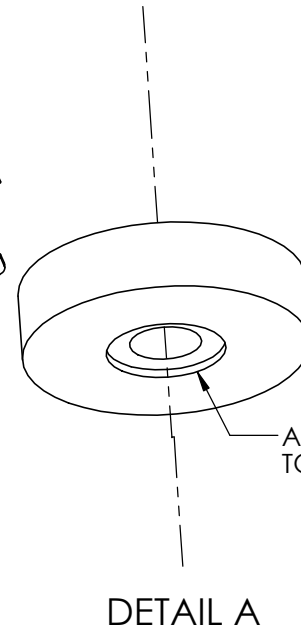

PICTURE # 5

ITEM #	PART #	DESCRIPTION	QTY.
1	52033	1 1/2 ROUND CASTER INSERT (EXISTING)	3
2	52146	50mm SOFT WHEEL HOODED CASTER (EXISTING)	3
3	50733	3/8 x 1 1/2 x 3/8 PLASTIC WASHER	3
4	50733 MOD	3/8 x 1 1/2 x 3/8 PLASTIC WASHER MODIFIED	3
5	STEM	REPLACEMENT STEM FOR VerSit SEAT BASE	3
6	52621	3" OMEGA LOCKING CASTER	2
7	52622	3" OMEGA NON-LOCKING CASTER	2