

Desk Top Gas Lift SINGLE Platform Assembly Instructions

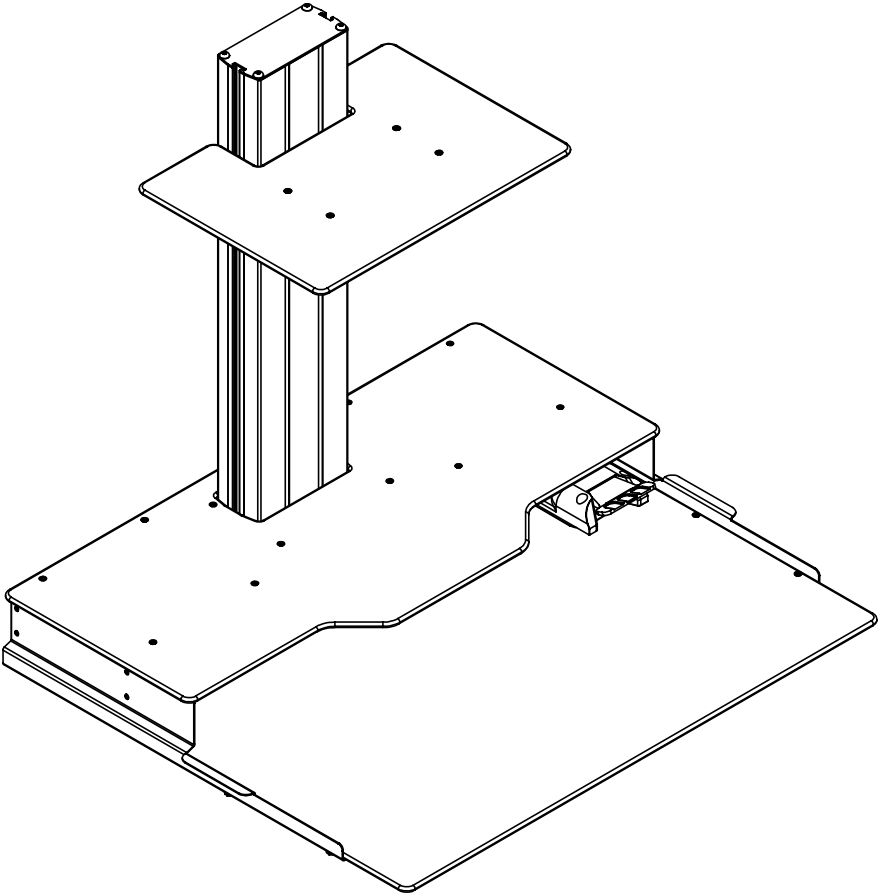

Hardware

53099 x2

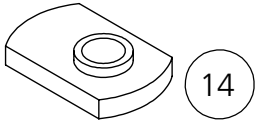

801580 x2

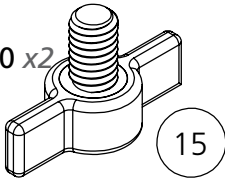

53580 x4 - Black
53779 x4 - White

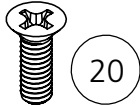

53648 x4 - Black
50267 x4 - White

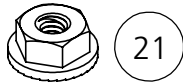

801585 x1

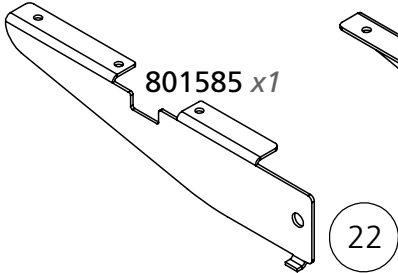

801586 x1

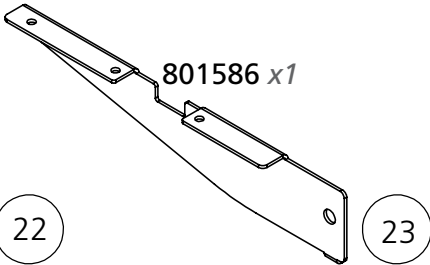

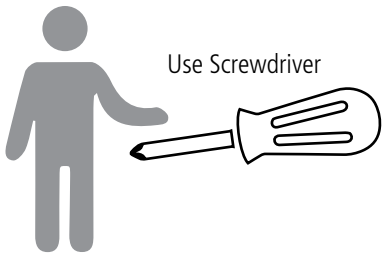

53099 x2

801580 x2

53580 x4 - Black
53779 x4 - White

53648 x4 - Black
50267 x4 - White

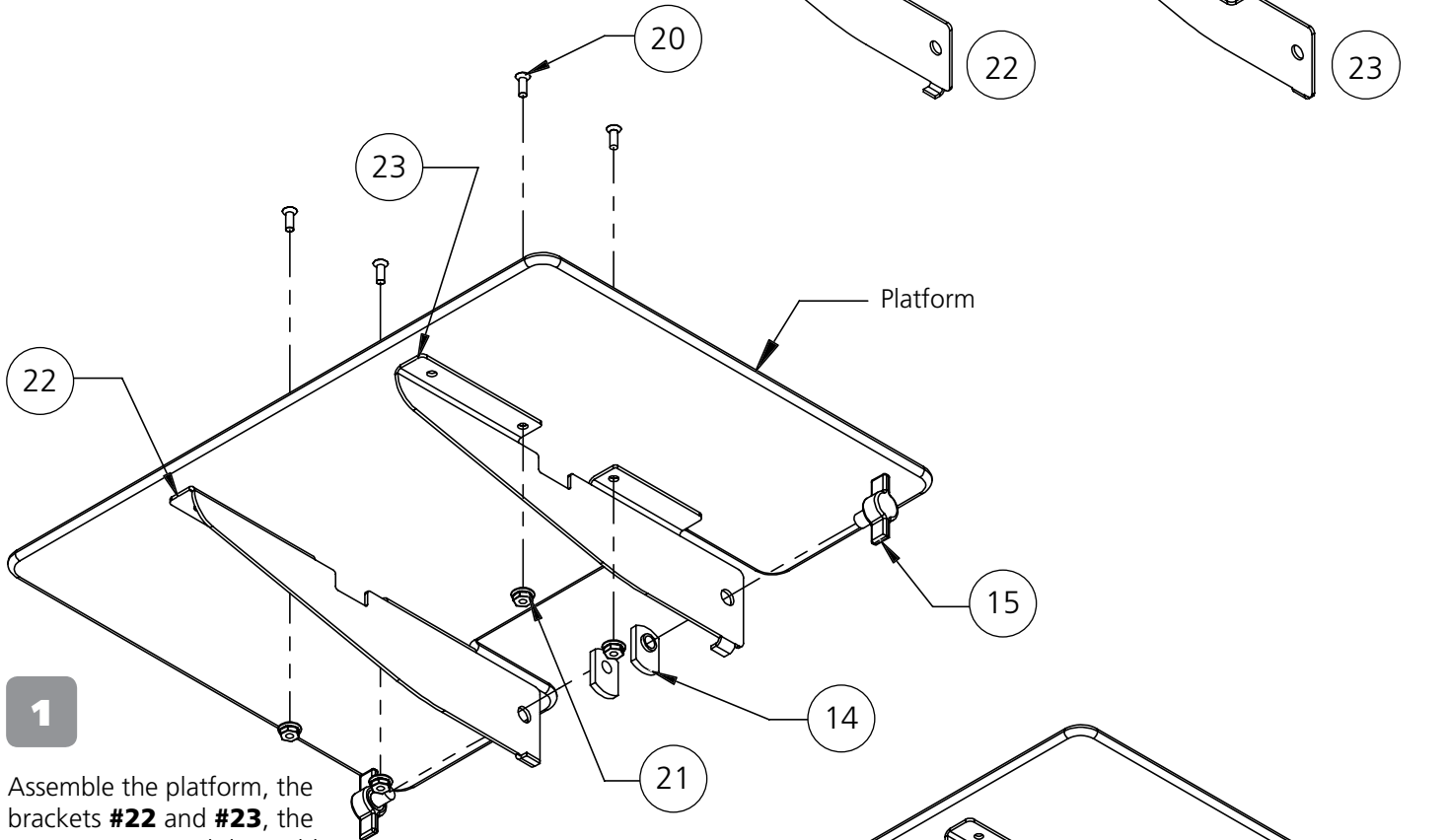
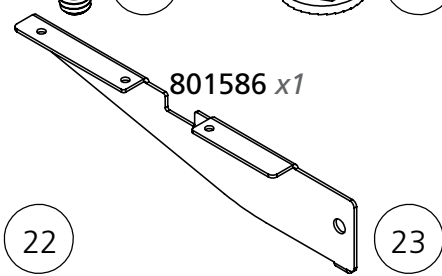
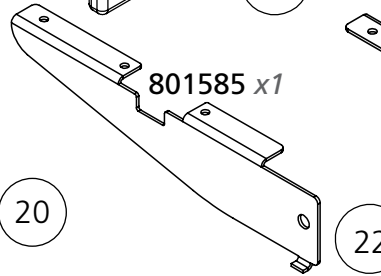
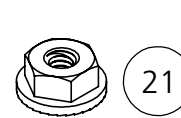
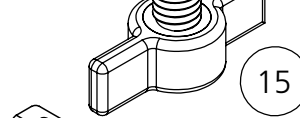
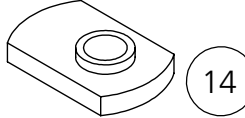

1

Assemble the platform, the brackets **#22** and **#23**, the T-screws **#15**, and the weld nuts **#14**. Leave the weld nuts and T-screws loose. Attach the platform to the brackets.

2

Slide the weld nuts into the grooves on the column assembly.

