

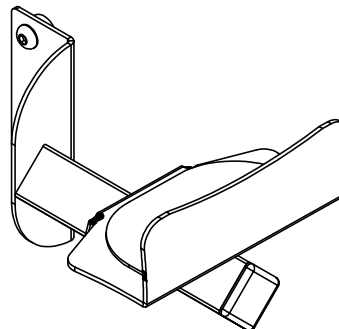

K&A Manufacturing
6703 Zinser Street
Schofield, WI 54476
Phone: 800.298.4351
Fax: 866.882.9475
www.raproducts.com
Version Dated: 4/15/16

310CPU Holder

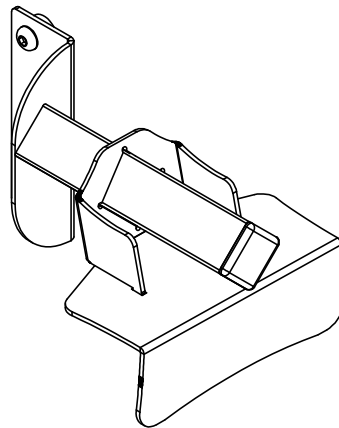

Read all the instructions before beginning.

Tools Required for Assembly:
 Power Driver W/Adjustable Torque
 3/16" Hex Head Driver Bit or
 Allen Wrench
 Tape Measure

Step 1: Measure the height of your CPU and determine the height at which you want the bottom of your CPU.

Step 2: Raise the workstation to its highest level. Raise the column cover as high as it will go. Tape it in place if necessary.

Step 3: Insert (2) socket screws 5 through the holes on CPU holder Assembly B 1 and thread them into the holes on a weld nut 4. Do not fully tighten.

Step 4: Slide the weld nut 4 into the groove at the front of the left leg assembly on your workstation. Slide it to the height you determined in Step 1 and fully tighten the socket screws 5.

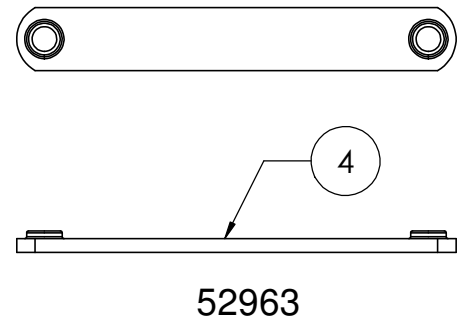
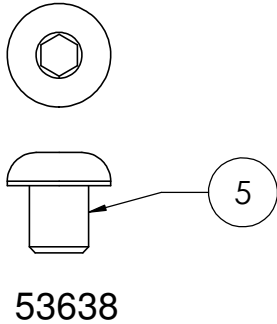
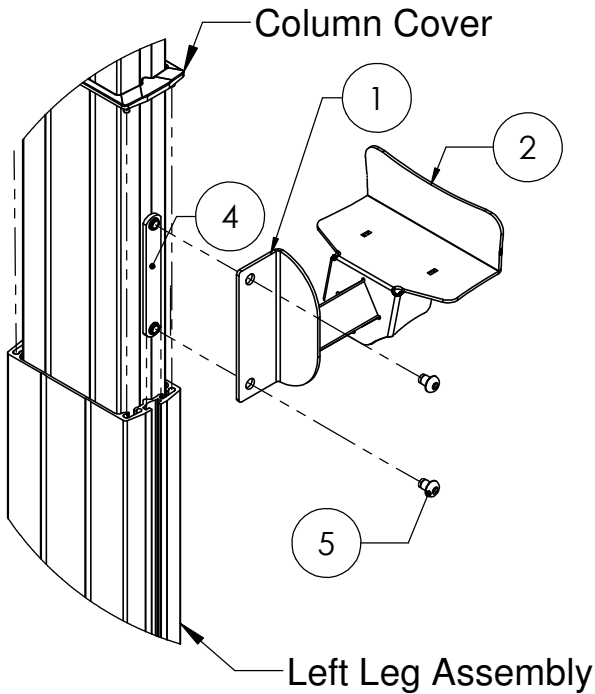

Hardware Pack # 51907 Drawn Actual Size

ITEM #	PART #	DESCRIPTION	QTY.
1	800166	310CPU Holder Assembly B	1
2	800224	310CPU Holder Support Bracket	2
3	800165	310CPU Holder Assembly A	1
4	52963	5/16-18 Weld Nut 4" CL'S	2
5	53638	5/16-18 x 3/8 Button Head Socket Screw	4

Step 5: Place your CPU onto CPU holder Assembly B 1 and slide the support bracket 2 tightly against the side of your CPU.

Step 6: Repeat Steps 3 and 4 with CPU Holder Assembly A 3. Slide Assembly A onto the top of the CPU. Slide the support bracket 2 tightly against the side of the CPU. Fully tighten the socket screws 5 .

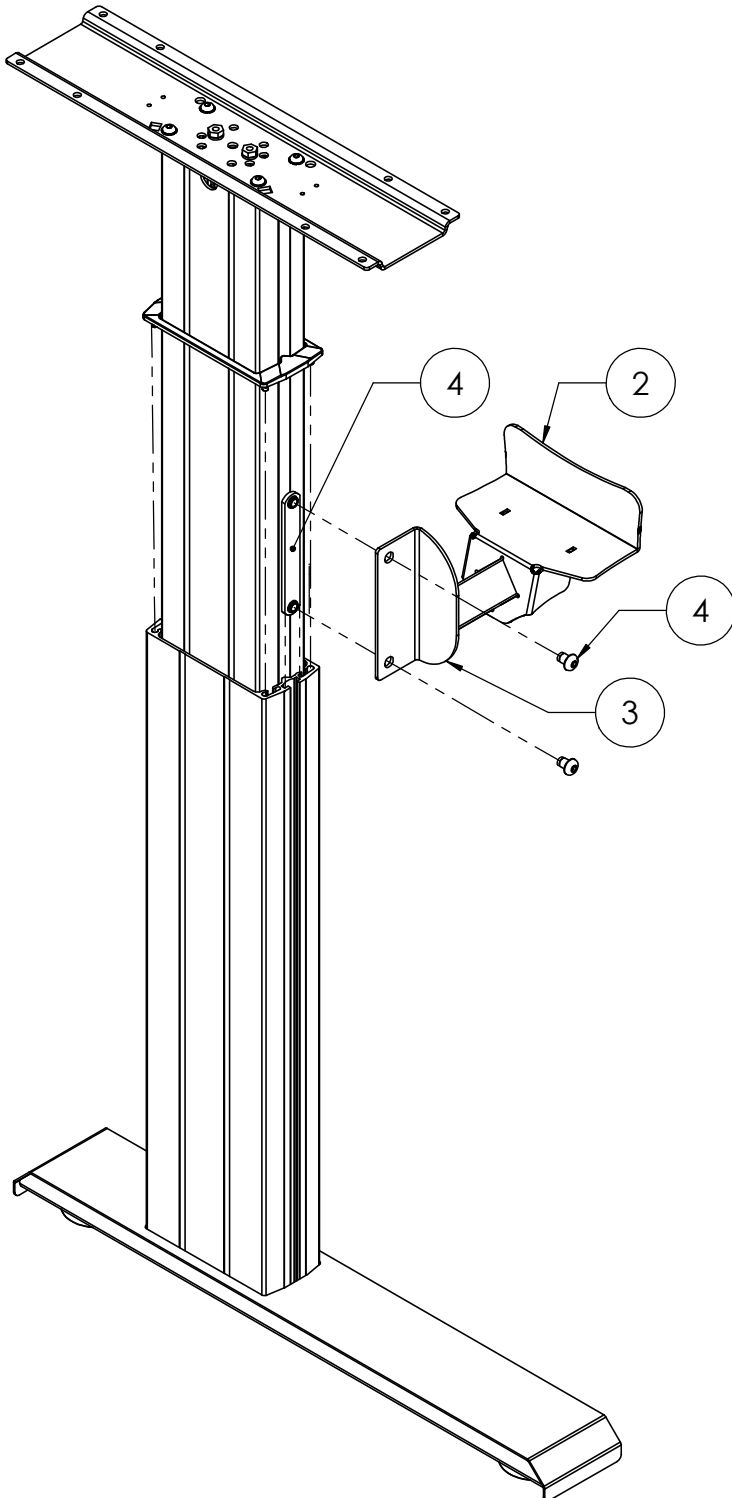

Note: To mount the CPU holder on the right leg assembly, reverse the locations of CPU Holder Assembly A 3 and CPU Holder Assembly B 1 .